

METAL PERFORATORS (M) SDN. BHD.

(Co. No. 12583-P)

CABLE SUPPORT SYSTEMS

(Cable Ladder, Tray, Trunking & Ducting)

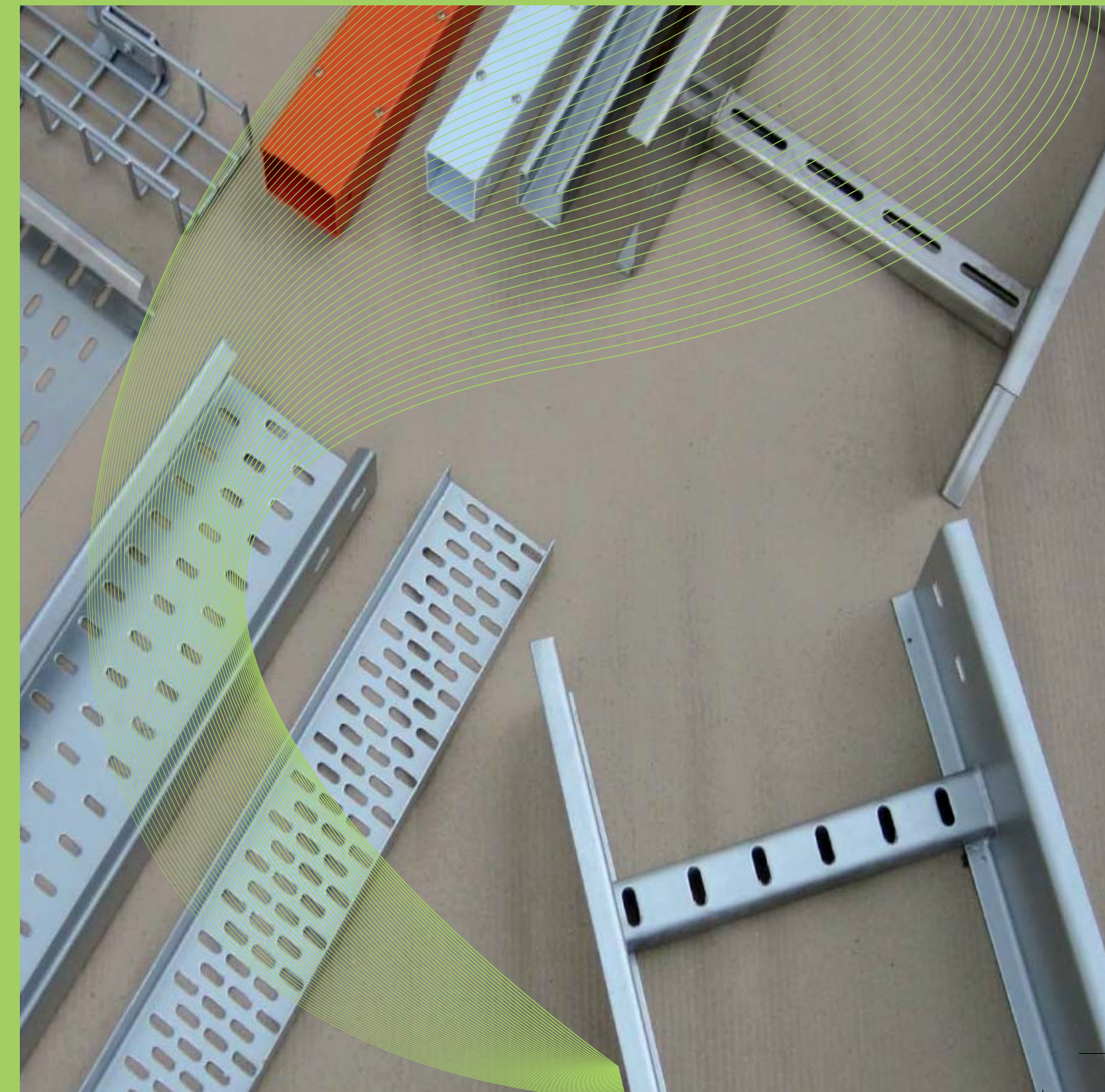

METAL PERFORATORS (M) SDN. BHD.

(Co. No. 12583-P)

Lot 5 & 7, Jalan Tukang 16/4, P.O. Box 7045,
40700 Shah Alam, Selangor Darul Ehsan,
Malaysia.

Tel : (603) 5519 1470
Fax : (603) 5519 6978
Website : www.metalperforators.com.my
E-mail : mpm@metalperforators.com.my
: sales@metalperforators.com.my



90° ANGLE FITTINGS BRACKET

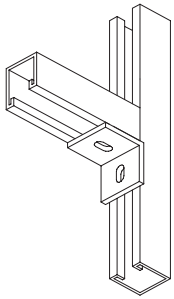

AF1

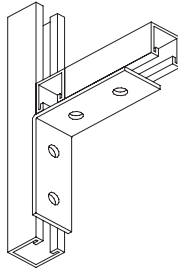

AF2

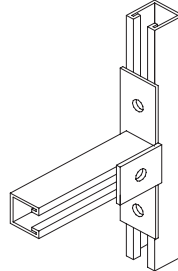

AF3

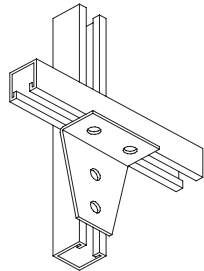

AF4

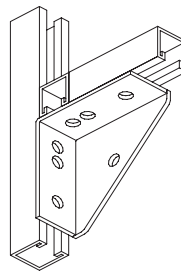

AF5

ANGULAR FITTING

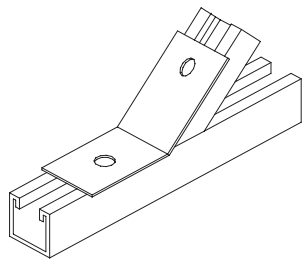

ARF1

'Z' SHAPE FITTING

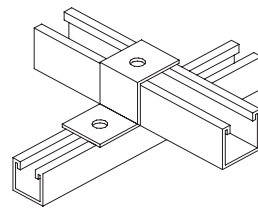

ZSF1

CONTENTS

The NEMA Standards	Prepage
Cable Ladder	1 ~ 16
Perforated Cable Tray	17 ~ 26
Wire Mesh Cable Tray	27 ~ 34
Cable Trunking	35 ~ 40
Cable Ducting	41 ~ 44
General Accessories	45 ~ 50



METAL PERFORATORS (M) SDN. BHD.

THE NEMA STANDARDS

NEMA STANDARD No. VE-1 is published by the National Electrical Manufacturers' Association in U.S.A. The standard provides for the technical requirements of construction, performance and testing of cable tray systems. It is regularly revised by the Association in order to keep pace with technology and the ever-changing requirements of the manufacturers, contractors, consultants and other users throughout the electrical industry.

There is presently no Malaysian Standard governing cable support systems. Despite the existence of other versions from places such as Canada and Europe, The VE-1 Code is by far the most widely accepted and the best known Standard for cable supports in Malaysia. In recognition of this situation, and in order to produce cable ladders of known quality and load capacity, MPM has adopted a policy of constructing and rating its cable support products in accordance with the VE-1 Code wherever possible. This policy is reflected in the name and various class designation numbers now used by MPM which are drawn directly from the code.

For example, NEMA Class 12A, 16B or 20B. Please note that most cases MPM ladders exceeds the minimum strength requirements of each ladder class and therefore the published load graphs should be consulted in order to find the actual safe load capacity for each ladder type.

The most important aspects of the NEMA Code which are relevant to MPM products are discussed below:-

1. Load Capacity and Safety Factor

Safe working loads are required to be determined as result of testing a series of sample ladders. Tests must be conducted as simple spans (i.e. the worst case for loading) and over various span lengths with a safety factor of 1.5 against the collapse load of ladder. In this way, loads are based on average performance of a number of samples and not just a single test or some calculations. The Code does not permit working loads to be determined by calculation because it has proven to be too unreliable. Cable ladders are specialist products which are unconventional in the structural sense. That is, they have an unusual combination of slenderness, local buckling of thin material and overall lateral restraint elements which are not satisfactorily interpreted by normal design methods.

2. Deflection

The NEMA Code does not specify any limitation on the deflection of cable support members. To do so would inevitably result in an overdesigned (and hence uneconomical) system.

3. Electrical Continuity

The electrical resistance of connections is limited to a maximum of 330 micro ohms.

Explanation of NEMA load/span class designations.

The NEMA rating method is based on the imperial system of measurement as follows:-

- | | |
|---|--|
| 1. The numerals indicate the ladder span in feet. | 2. The letter indicates the working load category. |
| 8 = 8ft (2.4m) | A = 50lbs/lin. ft. (75kgs/m) |
| 12 = 12ft (3.6m) | B = 75lbs/lin. ft (112kgs/m) |
| 16 = 16ft (4.8m) | C = 100lbs/lin. ft (149kgs/m) |
| 20 = 20ft (6.0m) | |

CABLE SUPPORT SYSTEMS - GENERAL ACCESSORIES

FLAT PLATE FITTINGS

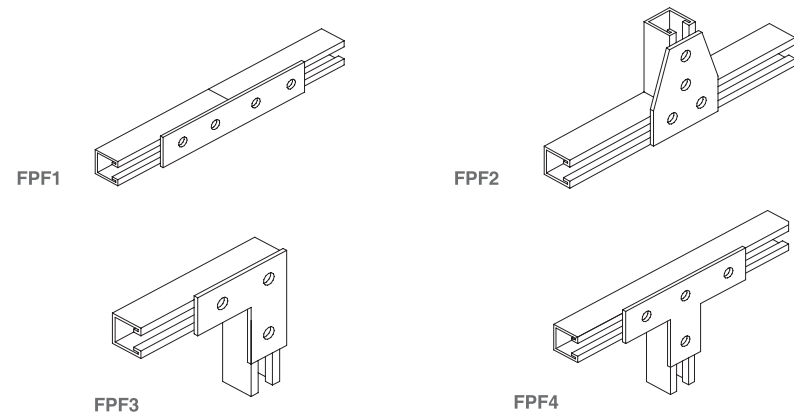

'U' SHAPE FITTINGS

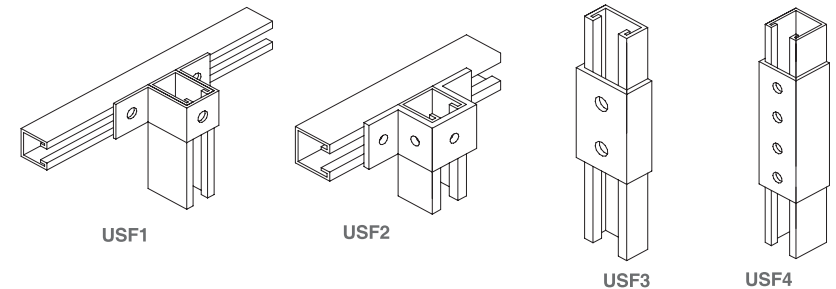

WING SHAPE FITTINGS

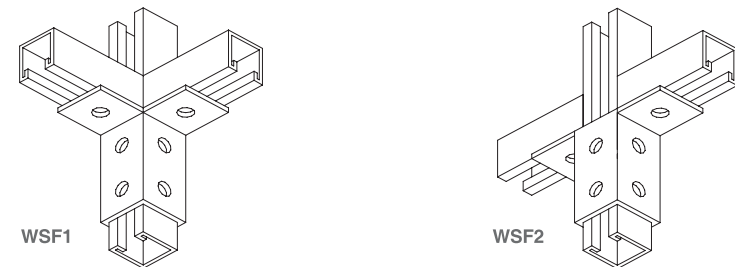

CABLE SUPPORT SYSTEMS - GENERAL ACCESSORIES

CONCRETE INSERT

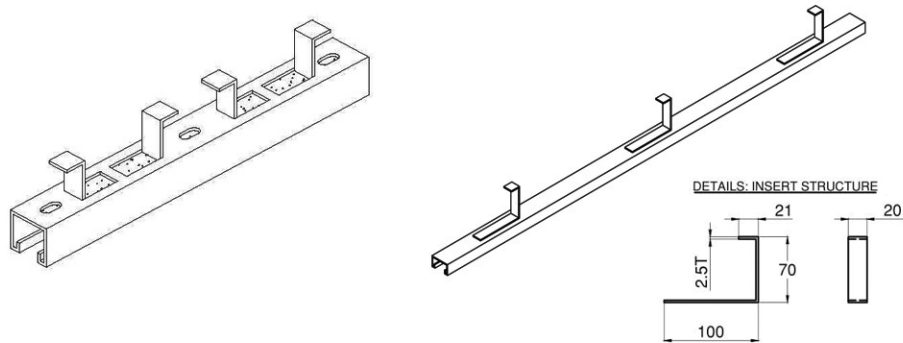

SINGLE BASE METAL FRAMING

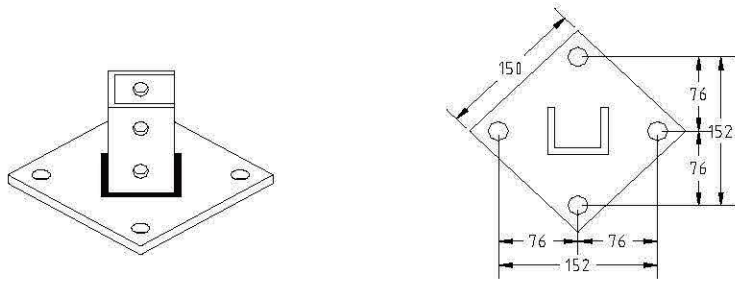

DOUBLE BASE METAL FRAMING

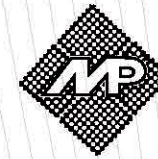
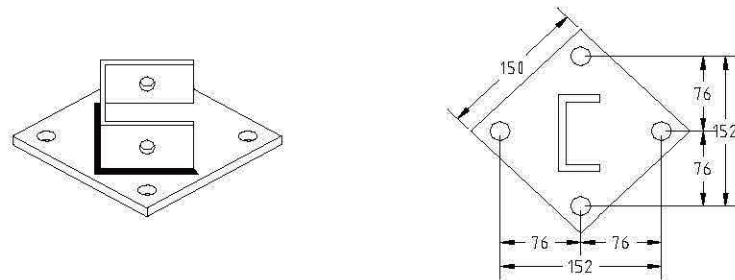

CABLE LADDER

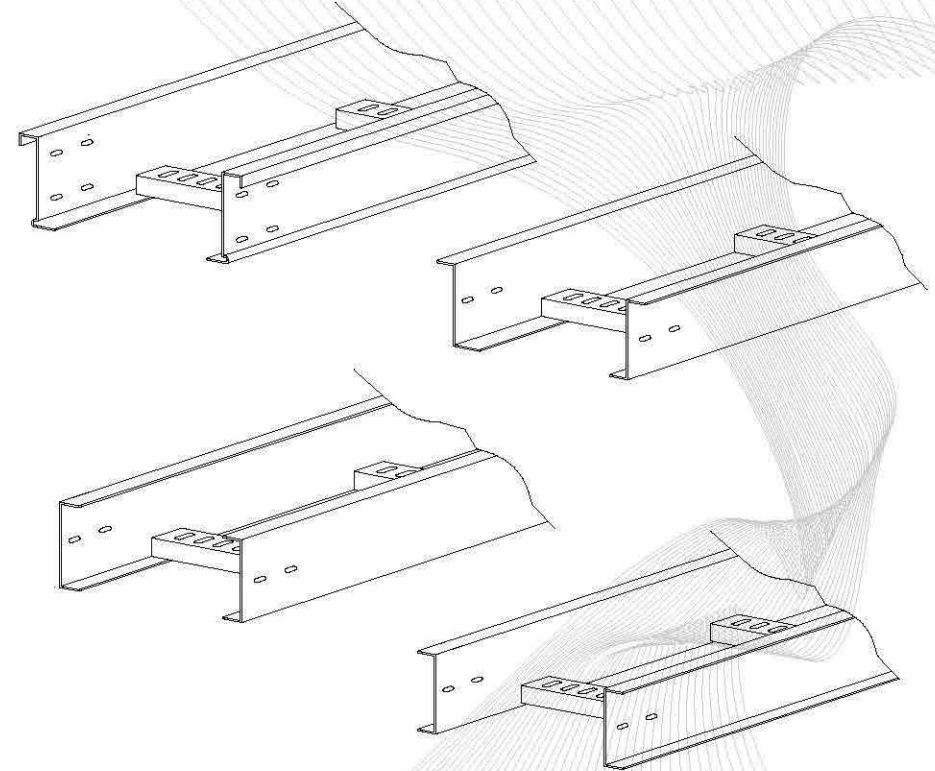

STRAIGHT CABLE LADDER

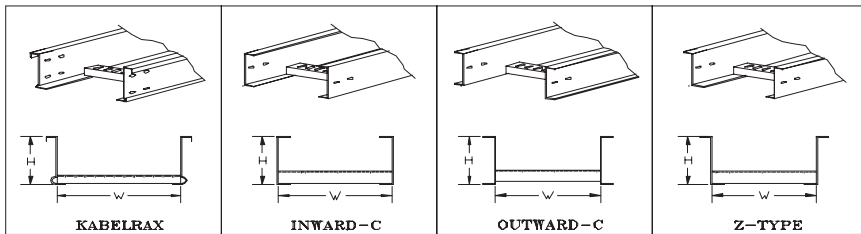
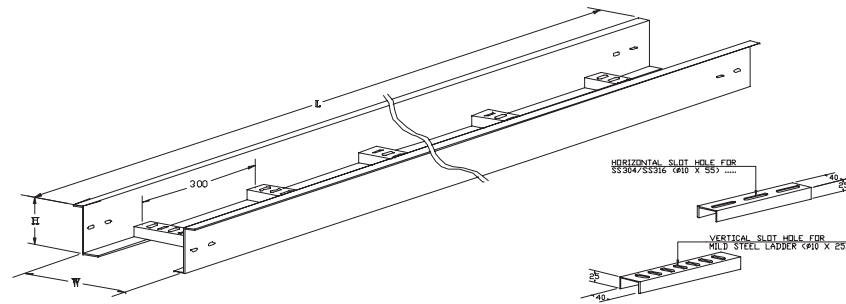

TYPE CODE : K

TYPE CODE : I

TYPE CODE : O

TYPE CODE : Z

Z TYPE		INWARD C		OUTWARD C		KABELRAX		STANDARD DIMENSION		
PART NO.	PART NO.	PART NO.	PART NO.	PART NO.	PART NO.	W(mm)	H(mm)	L(mm)		
MPZSL/100/150	MPISL/100/150	MPOSL/100/150	MPKSL/100/150	150	100	3000	100	3000		
MPZSL/100/200	MPISL/100/200	MPOSL/100/200	MPKSL/100/200	200						
MPZSL/100/300	MPISL/100/300	MPOSL/100/300	MPKSL/100/300	300						
MPZSL/100/450	MPISL/100/450	MPOSL/100/450	MPKSL/100/450	450						
MPZSL/100/600	MPISL/100/600	MPOSL/100/600	MPKSL/100/600	600						
MPZSL/100/750	MPISL/100/750	MPOSL/100/750	MPKSL/100/750	750						
MPZSL/100/900	MPISL/100/900	MPOSL/100/900	MPKSL/100/900	900	125	3000	125	3000		
MPZSL/125/150	MPISL/125/150	MPOSL/125/150	MPKSL/125/150	150						
MPZSL/125/200	MPISL/125/200	MPOSL/125/200	MPKSL/125/200	200						
MPZSL/125/300	MPISL/125/300	MPOSL/125/300	MPKSL/125/300	300						
MPZSL/125/450	MPISL/125/450	MPOSL/125/450	MPKSL/125/450	450						
MPZSL/125/600	MPISL/125/600	MPOSL/125/600	MPKSL/125/600	600						
MPZSL/125/750	MPISL/125/750	MPOSL/125/750	MPKSL/125/750	750	150	3000	150	3000		
MPZSL/125/900	MPISL/125/900	MPOSL/125/900	MPKSL/125/900	900						
MPZSL/150/150	MPISL/150/150	MPOSL/150/150	MPKSL/150/150	150						
MPZSL/150/200	MPISL/150/200	MPOSL/150/200	MPKSL/150/200	200						
MPZSL/150/300	MPISL/150/300	MPOSL/150/300	MPKSL/150/300	300						
MPZSL/150/450	MPISL/150/450	MPOSL/150/450	MPKSL/150/450	450						
MPZSL/150/600	MPISL/150/600	MPOSL/150/600	MPKSL/150/600	600						
MPZSL/150/750	MPISL/150/750	MPOSL/150/750	MPKSL/150/750	750						
MPZSL/150/900	MPISL/150/900	MPOSL/150/900	MPKSL/150/900	900						

NOTE : Other sizes are available upon request

Standard Specifications:

- MATERIAL : Hot/Cold Rolled Mild Steel/SS304/SS316
- STD LENGTH : 3000 mm (± 6mm)
- THICKNESS : 1.5mm to 3.0mm
- RUNG SPACING : 300 mm
- FINISHING : HDG (ISO 1461/ BS 729 / ASTM A386)

Example: MPZSL/100/150

- MP : Metal Perforators
 Z : Z type
 SL : Straight Ladder
 100 : 100mm Height
 150 : 150mm Width

CABLE SUPPORT SYSTEMS - CANTILEVER BRACKET

SINGLE BASE & CHANNEL CANTILEVER BRACKET

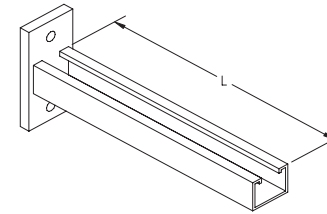

PART NO.	L (mm)	Ladder/Tray Width (mm)
MPBSBCB15	300	150
MPBSBCB20	350	200
MPBSBCB30	450	300
MPBSBCB45	600	450
MPBSBCB60	750	600
MPBSBCB75	900	750
MPBSBCB90	1050	900
MPBSBCB100	1150	1000

DOUBLE BASE & SINGLE CHANNEL CANTILEVER BRACKET

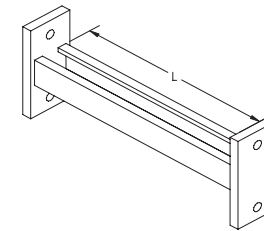

PART NO.	L (mm)	Ladder/Tray Width (mm)
MPDBSCB15	300	150
MPDBSCB20	350	200
MPDBSCB30	450	300
MPDBSCB45	600	450
MPDBSCB60	750	600
MPDBSCB75	900	750
MPDBSCB90	1050	900
MPDBSCB100	1150	1000

SINGLE BASE & DOUBLE CHANNEL CANTILEVER BRACKET

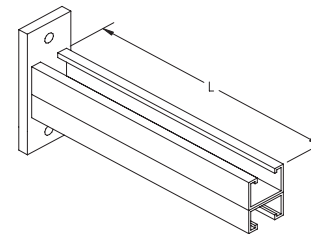

PART NO.	L (mm)	Ladder/Tray Width (mm)
MPSBDCB15	300	150
MPSBDCB20	350	200
MPSBDCB30	450	300
MPSBDCB45	600	450
MPSBDCB60	750	600
MPSBDCB75	900	750
MPSBDCB90	1050	900
MPSBDCB100	1150	1000

DOUBLE BASE & DOUBLE CHANNEL CANTILEVER BRACKET

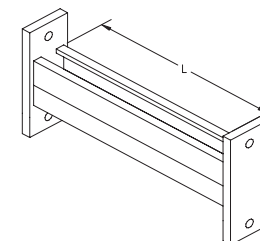

PART NO.	L (mm)	Ladder/Tray Width (mm)
MPDBDCB15	300	150
MPDBDCB20	350	200
MPDBDCB30	450	300
MPDBDCB45	600	450
MPDBDCB60	750	600
MPDBDCB75	900	750
MPDBDCB90	1050	900
MPDBDCB100	1150	1000

CABLE SUPPORT SYSTEMS - STAND SUPPORT

FLOOR/CEILING STAND

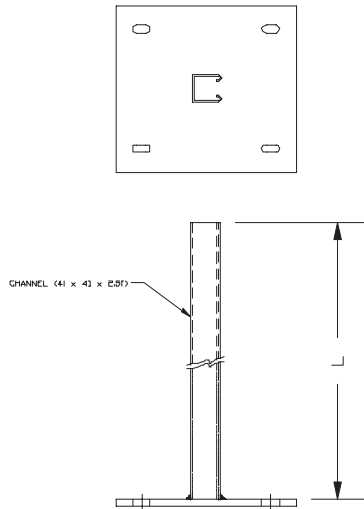

INSTRUMENT STANCHION

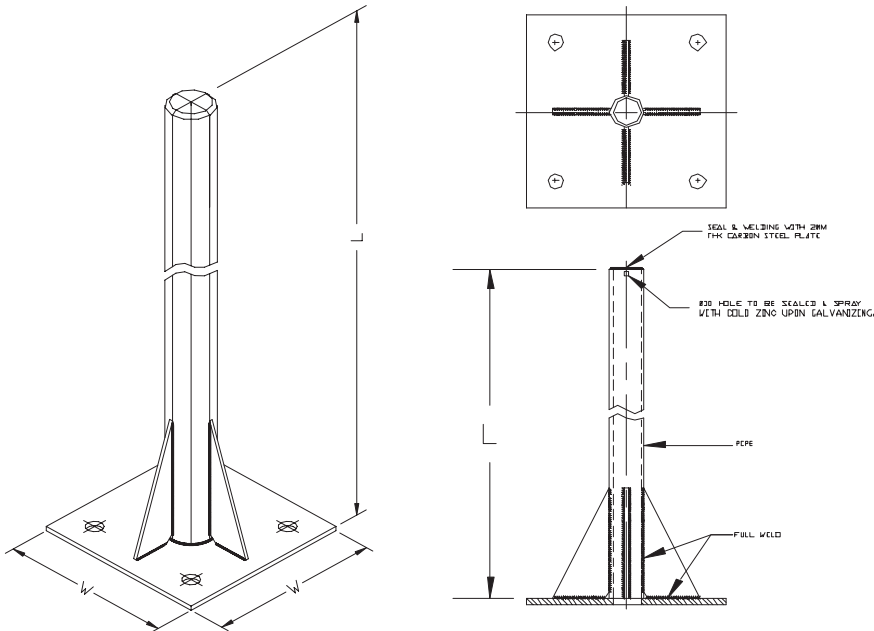

HORIZONTAL ELBOW 90°

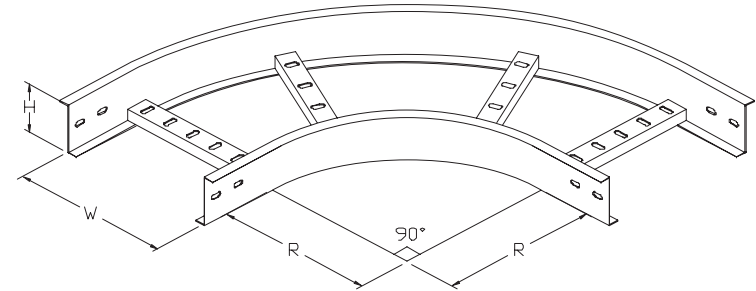

Z-TYPE	INWARD C	OUTWARD C	KABELRAX	STANDARD DIMENSION		
PART NO.	PART NO.	PART NO.	PART NO.	H(mm)	W(mm)	R (mm)
MPLZEL90/100/15	MPLIEL90/100/15	MPLOEL90/100/15	MPLKEL90/100/15	100	150	R300 to R900
MPLZEL90/100/20	MPLIEL90/100/20	MPLOEL90/100/20	MPLKEL90/100/20		200	
MPLZEL90/100/30	MPLIEL90/100/30	MPLOEL90/100/30	MPLKEL90/100/30		300	
MPLZEL90/100/45	MPLIEL90/100/45	MPLOEL90/100/45	MPLKEL90/100/45		450	
MPLZEL90/100/60	MPLIEL90/100/60	MPLOEL90/100/60	MPLKEL90/100/60		600	
MPLZEL90/100/75	MPLIEL90/100/75	MPLOEL90/100/75	MPLKEL90/100/75		750	
MPLZEL90/100/90	MPLIEL90/100/90	MPLOEL90/100/90	MPLKEL90/100/90	900		
MPLZEL90/125/15	MPLIEL90/125/15	MPLOEL90/125/15	MPLKEL90/125/15	125	150	R300 to R900
MPLZEL90/125/20	MPLIEL90/125/20	MPLOEL90/125/20	MPLKEL90/125/20		200	
MPLZEL90/125/30	MPLIEL90/125/30	MPLOEL90/125/30	MPLKEL90/125/30		300	
MPLZEL90/125/45	MPLIEL90/125/45	MPLOEL90/125/45	MPLKEL90/125/45		450	
MPLZEL90/125/60	MPLIEL90/125/60	MPLOEL90/125/60	MPLKEL90/125/60		600	
MPLZEL90/125/75	MPLIEL90/125/75	MPLOEL90/125/75	MPLKEL90/125/75		750	
MPLZEL90/125/90	MPLIEL90/125/90	MPLOEL90/125/90	MPLKEL90/125/90	900		
MPLZEL90/150/15	MPLIEL90/150/15	MPLOEL90/150/15	MPLKEL90/150/15	150	150	R300 to R900
MPLZEL90/150/20	MPLIEL90/150/20	MPLOEL90/150/20	MPLKEL90/150/20		200	
MPLZEL90/150/30	MPLIEL90/150/30	MPLOEL90/150/30	MPLKEL90/150/30		300	
MPLZEL90/150/45	MPLIEL90/150/45	MPLOEL90/150/45	MPLKEL90/150/45		450	
MPLZEL90/150/60	MPLIEL90/150/60	MPLOEL90/150/60	MPLKEL90/150/60		600	
MPLZEL90/150/75	MPLIEL90/150/75	MPLOEL90/150/75	MPLKEL90/150/75		750	
MPLZEL90/150/90	MPLIEL90/150/90	MPLOEL90/150/90	MPLKEL90/150/90	900		

NOTE : Other sizes are available upon request

Standard Specifications:

1. TYPE : Z - Type, Outward C, Inward C and Kabelrax
2. MATERIAL : Mild Steel / SS 304 / SS 316
3. THICKNESS : 1.5mm to 3.0mm
4. RADIUS : R300mm to R900mm (Standard R300mm)
5. FINISHING : HDG - ISO 1461 / BS 729 / ASTM A386
6. FASTENERS : HDG, EZP, SS 304 & SS 316

REMARKS :

- MP : METAL PERFORATORS
- L : LADDER
- EL90 : HORIZONTAL ELBOW 90°
- Z : Z-TYPE
- K : KABELRAX
- O : OUTWARD C
- I : INWARD C

EXAMPLE : MPLZEL90/100/15
 METAL PERFORATORS
 Z TYPE LADDER
 HORIZONTAL ELBOW 90° 100H X 150W

HORIZONTAL EQUAL TEE

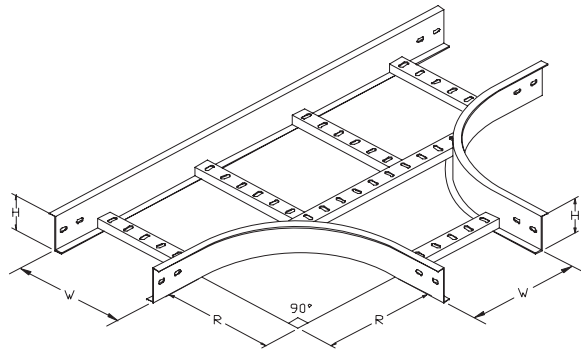

GENERAL ACCESSORIES

Z-TYPE		INWARD C		OUTWARD C		KABELRAX		STANDARD DIMENSION		
PART NO.	PART NO.	PART NO.	PART NO.	PART NO.	PART NO.	H(mm)	W(mm)	R (mm)		
MPLZET/100/15	MPLIET/100/15	MPLOET/100/15	MPLKET/100/15			100	150	R300 to R900		
MPLZET/100/20	MPLIET/100/20	MPLOET/100/20	MPLKET/100/20				200			
MPLZET/100/30	MPLIET/100/30	MPLOET/100/30	MPLKET/100/30				300			
MPLZET/100/45	MPLIET/100/45	MPLOET/100/45	MPLKET/100/45				450			
MPLZET/100/60	MPLIET/100/60	MPLOET/100/60	MPLKET/100/60				600			
MPLZET/100/75	MPLIET/100/75	MPLOET/100/75	MPLKET/100/75				750			
MPLZET/100/90	MPLIET/100/90	MPLOET/100/90	MPLKET/100/90				900			
MPLZET/125/15	MPLIET/125/15	MPLOET/125/15	MPLKET/125/15			125	150	R300 to R900		
MPLZET/125/20	MPLIET/125/20	MPLOET/125/20	MPLKET/125/20				200			
MPLZET/125/30	MPLIET/125/30	MPLOET/125/30	MPLKET/125/30				300			
MPLZET/125/45	MPLIET/125/45	MPLOET/125/45	MPLKET/125/45				450			
MPLZET/125/60	MPLIET/125/60	MPLOET/125/60	MPLKET/125/60				600			
MPLZET/125/75	MPLIET/125/75	MPLOET/125/75	MPLKET/125/75				750			
MPLZET/125/90	MPLIET/125/90	MPLOET/125/90	MPLKET/125/90				900			
MPLZET/150/15	MPLIET/150/15	MPLOET/150/15	MPLKET/150/15			150	150	R300 to R900		
MPLZET/150/20	MPLIET/150/20	MPLOET/150/20	MPLKET/150/20				200			
MPLZET/150/30	MPLIET/150/30	MPLOET/150/30	MPLKET/150/30				300			
MPLZET/150/45	MPLIET/150/45	MPLOET/150/45	MPLKET/150/45				450			
MPLZET/150/60	MPLIET/150/60	MPLOET/150/60	MPLKET/150/60				600			
MPLZET/150/75	MPLIET/150/75	MPLOET/150/75	MPLKET/150/75				750			
MPLZET/150/90	MPLIET/150/90	MPLOET/150/90	MPLKET/150/90				900			

NOTE : Other sizes are available upon request

Standard Specifications:

1. TYPE : Z - Type, Outward C, Inward C and Kabelrax
2. MATERIAL : Mild Steel / SS 304 / SS 316
3. THICKNESS : 1.5mm to 3.0mm
4. RADIUS : R300mm to R900mm (Standard R300mm)
5. FINISHING : HDG - ISO 1461 / BS 729 / ASTM A386
6. FASTENERS : HDG, EZP, SS 304 & SS 316

REMARKS :

MP : METAL PERFORATORS
 L : LADDER
 Z : Z-TYPE
 K : KABELRAX
 O : OUTWARD C
 I : INWARD C

EXAMPLE : MPLZET/100/15
 METAL PERFORATORS
 Z TYPE LADDER
 HORIZONTAL EQUAL TEE 100H X 150W

DUCT - INTERNAL VERTICAL RISER 90°

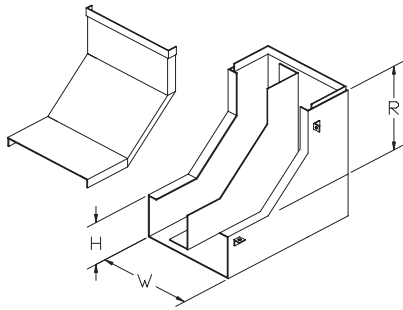

DUCT - EXTERNAL VERTICAL RISER 90°

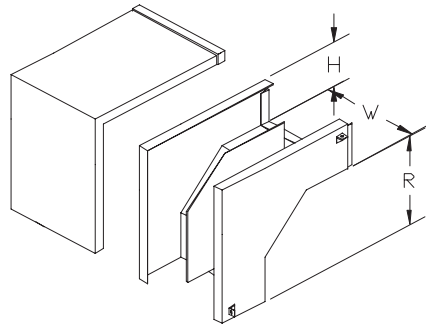

STANDARD DIMENSION					STANDARD DIMENSION									
PART NO	W (mm)	H (mm)	Radius	T (mm)	PART NO	W (mm)	H (mm)	Radius	T (mm)					
MPCDIR90/150/200	200	150	R300	2.0	MPCDOR90/150/200	200	150	R300	2.0					
MPCDIR90/150/300	300				MPCDOR90/150/300	300								
MPCDIR90/150/400	400				MPCDOR90/150/400	400								
MPCDIR90/150/500	500				MPCDOR90/150/500	500								
MPCDIR90/150/600	600				MPCDOR90/150/600	600								
MPCDIR90/150/800	800			MPCDOR90/150/800	800	3.0								
MPCDIR90/150/1000	1000			MPCDOR90/150/1000	1000									
MPCDIR90/200/200	200			200	R300				2.0	MPCDOR90/200/200	200	200	R300	2.0
MPCDIR90/200/300	300									MPCDOR90/200/300	300			
MPCDIR90/200/400	400									MPCDOR90/200/400	400			
MPCDIR90/200/500	500	MPCDOR90/200/500	500											
MPCDIR90/200/600	600	MPCDOR90/200/600	600											
MPCDIR90/200/800	800	MPCDOR90/200/800	800			3.0								
MPCDIR90/200/1000	1000	MPCDOR90/200/1000	1000											
MPCDIR90/250/300	300	250	R300				3.0	MPCDOR90/250/300	300	250	R300			2.0
MPCDIR90/250/400	400							MPCDOR90/250/400	400					
MPCDIR90/250/500	500							MPCDOR90/250/500	500					
MPCDIR90/250/600	600			MPCDOR90/250/600	600									
MPCDIR90/250/800	800			MPCDOR90/250/800	800									
MPCDIR90/250/1000	1000			MPCDOR90/250/1000	1000	3.0								
MPCDIR90/400/400	400			MPCDOR90/400/400	400		400	R300	3.0					
MPCDIR90/400/500	500			MPCDOR90/400/500	500									
MPCDIR90/400/600	600			MPCDOR90/400/600	600									
MPCDIR90/400/800	800			MPCDOR90/400/800	800									
MPCDIR90/400/1000	1000	MPCDOR90/400/1000	1000											

NOTE : Other sizes are available upon request

Standard Specifications:

- MATERIAL : Mild Steel / SS 304 / SS 316
- FINISHING : HDG - ISO 1461 / BS 729 / ASTM A386
- FASTENERS : HDG, EZP, SS 304 & SS 316

REMARKS:

- MP : METAL PERFORATED
 CD : CABLE DUCT
 IR90 : INSIDE RISER 90°
 OR90 : OUTSIDE RISER 90

- Example: MPCDIR90/150/200**
 METAL PERFORATORS
 CABLE DUCT INSIDE RISER 90°
 150H X 200W X R300 X 2T

HORIZONTAL UNEQUAL TEE

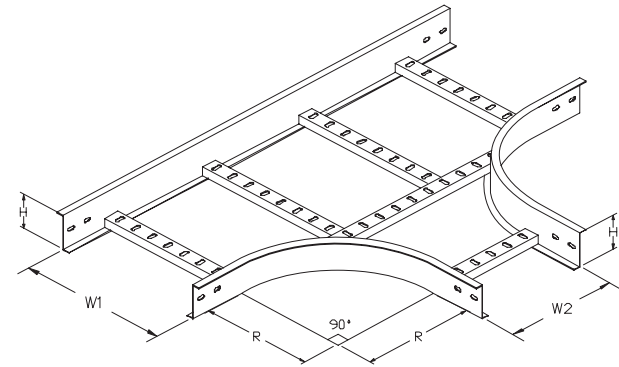

Z-TYPE	INWARD C	OUTWARD C	KABELRAX	STANDARD DIMENSION			
PART NO.	PART NO.	PART NO.	PART NO.	H(mm)	W1(mm)	W2(mm)	Radius
MPLZUT/100/20-15	MPLIUT/100/20-15	MPLOUT/100/20-15	MPLKUT/100/20-15	100	200	150	R300 to R900
MPLZUT/100/30-20	MPLIUT/100/30-20	MPLOUT/100/30-20	MPLKUT/100/30-20		300	200	
MPLZUT/100/45-30	MPLIUT/100/45-30	MPLOUT/100/45-30	MPLKUT/100/45-30		450	300	
MPLZUT/100/60-45	MPLIUT/100/60-45	MPLOUT/100/60-45	MPLKUT/100/60-45		600	450	
MPLZUT/100/75-60	MPLIUT/100/75-60	MPLOUT/100/75-60	MPLKUT/100/75-60		750	600	
MPLZUT/100/90-75	MPLIUT/100/90-75	MPLOUT/100/90-75	MPLKUT/100/90-75		900	750	
MPLZUT/125/20-15	MPLIUT/125/20-15	MPLOUT/125/20-15	MPLKUT/125/20-15	125	200	150	R300 to R900
MPLZUT/125/30-20	MPLIUT/125/30-20	MPLOUT/125/30-20	MPLKUT/125/30-20		300	200	
MPLZUT/125/45-30	MPLIUT/125/45-30	MPLOUT/125/45-30	MPLKUT/125/45-30		450	300	
MPLZUT/125/60-45	MPLIUT/125/60-45	MPLOUT/125/60-45	MPLKUT/125/60-45		600	450	
MPLZUT/125/75-60	MPLIUT/125/75-60	MPLOUT/125/75-60	MPLKUT/125/75-60		750	600	
MPLZUT/125/90-75	MPLIUT/125/90-75	MPLOUT/125/90-75	MPLKUT/125/90-75		900	750	
MPLZUT/150/20-15	MPLIUT/150/20-15	MPLOUT/150/20-15	MPLKUT/150/20-15	150	200	150	R300 to R900
MPLZUT/150/30-20	MPLIUT/150/30-20	MPLOUT/150/30-20	MPLKUT/150/30-20		300	200	
MPLZUT/150/45-30	MPLIUT/150/45-30	MPLOUT/150/45-30	MPLKUT/150/45-30		450	300	
MPLZUT/150/60-45	MPLIUT/150/60-45	MPLOUT/150/60-45	MPLKUT/150/60-45		600	450	
MPLZUT/150/75-60	MPLIUT/150/75-60	MPLOUT/150/75-60	MPLKUT/150/75-60		750	600	
MPLZUT/150/90-75	MPLIUT/150/90-75	MPLOUT/150/90-75	MPLKUT/150/90-75		900	750	

NOTE : Other sizes are available upon request

Standard Specifications:

- TYPE : Z - Type, Outward C, Inward C and Kabelrax
- MATERIAL : Mild Steel / SS 304 / SS 316
- THICKNESS : 1.5mm to 3.0mm
- RADIUS : R300mm to R900mm (Standard R300mm)
- FINISHING : HDG - ISO 1461 / BS 729 / ASTM A386
- FASTENERS : HDG, EZP, SS 304 & SS 316

REMARKS :

- MP : METAL PERFORATORS
 L : LADDER
 Z : Z-TYPE
 K : KABELRAX
 O : OUTWARD C
 I : INWARD C

- EXAMPLE : MPLZUT/100/20-15**
 METAL PERFORATORS
 Z TYPE LADDER
 UNEQUAL TEE 100H X 200W-150W

HORIZONTAL EQUAL CROSS

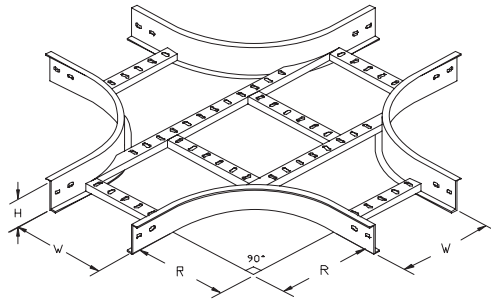

Z-TYPE		INWARD C		OUTWARD C		KABELRAX		STANDARD DIMENSION		
PART NO.	PART NO.	PART NO.	PART NO.	H(mm)	W1(mm)	Radius				
MPLZEX/100/15	MPLIEX/100/15	MPLLOEX/100/15	MPLKEX/100/15	100	150	R300 to R900				
MPLZEX/100/20	MPLIEX/100/20	MPLLOEX/100/20	MPLKEX/100/20		200					
MPLZEX/100/30	MPLIEX/100/30	MPLLOEX/100/30	MPLKEX/100/30		300					
MPLZEX/100/45	MPLIEX/100/45	MPLLOEX/100/45	MPLKEX/100/45		450					
MPLZEX/100/60	MPLIEX/100/60	MPLLOEX/100/60	MPLKEX/100/60		600					
MPLZEX/100/75	MPLIEX/100/75	MPLLOEX/100/75	MPLKEX/100/75		750					
MPLZEX/100/90	MPLIEX/100/90	MPLLOEX/100/90	MPLKEX/100/90	900						
MPLZEX/125/15	MPLIEX/125/15	MPLLOEX/125/15	MPLKEX/125/15	125	150	R300 to R900				
MPLZEX/125/20	MPLIEX/125/20	MPLLOEX/125/20	MPLKEX/125/20		200					
MPLZEX/125/30	MPLIEX/125/30	MPLLOEX/125/30	MPLKEX/125/30		300					
MPLZEX/125/45	MPLIEX/125/45	MPLLOEX/125/45	MPLKEX/125/45		450					
MPLZEX/125/60	MPLIEX/125/60	MPLLOEX/125/60	MPLKEX/125/60		600					
MPLZEX/125/75	MPLIEX/125/75	MPLLOEX/125/75	MPLKEX/125/75		750					
MPLZEX/125/90	MPLIEX/125/90	MPLLOEX/125/90	MPLKEX/125/90	900						
MPLZEX/150/15	MPLIEX/150/15	MPLLOEX/150/15	MPLKEX/150/15	150	150	R300 to R900				
MPLZEX/150/20	MPLIEX/150/20	MPLLOEX/150/20	MPLKEX/150/20		200					
MPLZEX/150/30	MPLIEX/150/30	MPLLOEX/150/30	MPLKEX/150/30		300					
MPLZEX/150/45	MPLIEX/150/45	MPLLOEX/150/45	MPLKEX/150/45		450					
MPLZEX/150/60	MPLIEX/150/60	MPLLOEX/150/60	MPLKEX/150/60		600					
MPLZEX/150/75	MPLIEX/150/75	MPLLOEX/150/75	MPLKEX/150/75		750					
MPLZEX/150/90	MPLIEX/150/90	MPLLOEX/150/90	MPLKEX/150/90	900						

NOTE : Other sizes are available upon request

Standard Specifications:

1. TYPE : Z - Type, Outward C, Inward C and Kabelrax
2. MATERIAL : Mild Steel / SS 304 / SS 316
3. THICKNESS : 1.5mm to 3.0mm
4. RADIUS : R300mm to R900mm (Standard R300mm)
5. FINISHING : HDG Accordance to ISO 1461 / BS 729 / ASTM A386 for Mild Steel
6. FASTENERS : HDG, EZP, SS 304 & SS 316

REMARKS :

MP : METAL PERFORATORS
 L : LADDER
 EX : EQUAL CROSS
 Z : Z -TYPE
 K : KABELRAX
 O : OUTWARD C
 I : INWARD C

EXAMPLE : MPLZEX/100/15

METAL PERFORATORS
 Z TYPE LADDER
 HORIZONTAL EQUAL CROSS 100H X 150W

DUCT - HORIZONTAL TEE

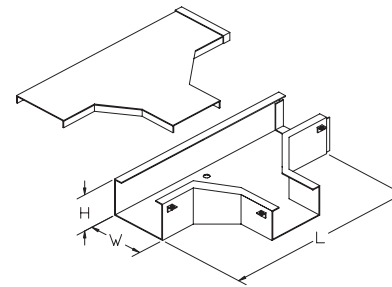

STANDARD DIMENSION				
PART NO	W (mm)	H (mm)	Radius	T (mm)
MPCDHT/150/200	200	150	R300	2.0
MPCDHT/150/300	300			
MPCDHT/150/400	400			
MPCDHT/150/500	500			
MPCDHT/150/600	600			
MPCDHT/150/800	800			
MPCDHT/150/1000	1000			3.0
MPCDHT/200/200	200	200	R300	
MPCDHT/200/300	300			
MPCDHT/200/400	400			
MPCDHT/200/500	500			
MPCDHT/200/600	600			
MPCDHT/200/800	800			
MPCDHT/200/1000	1000			3.0
MPCDHT/250/200	300	250	R300	
MPCDHT/250/400	400			
MPCDHT/250/600	500			
MPCDHT/250/1000	600			
MPCDHT/250/1001	601			
MPCDHT/250/1002	602			
MPCDHT/400/400	400	400	R300	3.0
MPCDHT/400/500	500			
MPCDHT/400/600	600			
MPCDHT/400/800	800			
MPCDHT/400/1000	1000			

Standard Specifications:

1. MATERIAL : Mild Steel / SS 304 / SS 316
2. FINISHING : HDG Accordance to ISO 1461 / BS 729 / ASTM A386 for M/S
3. FASTENERS : HDG, EZP, SS 304 & SS 316

REMARKS:

MP : METAL PERFORATORS
 CD : CABLE DUCT
 HT : HORIZONTAL TEE
 HE90 : HORIZONTAL ELBOW 90°

DUCT - HORIZONTAL ELBOW 90°

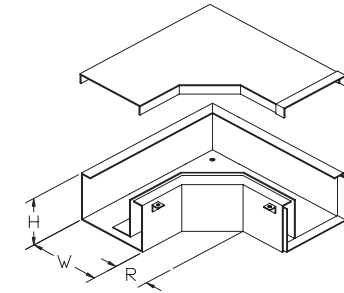

STANDARD DIMENSION				
PART NO	W (mm)	H (mm)	Radius	T (mm)
MPCDHE90/150/200	200	150	R300	2.0
MPCDHE90/150/300	300			
MPCDHE90/150/400	400			
MPCDHE90/150/500	500			
MPCDHE90/150/600	600			
MPCDHE90/150/800	800			
MPCDHE90/150/1000	1000			3.0
MPCDHE90/200/200	200	200	R300	
MPCDHE90/200/300	300			
MPCDHE90/200/400	400			
MPCDHE90/200/500	500			
MPCDHE90/200/600	600			
MPCDHE90/200/800	800			
MPCDHE90/200/1000	1000			3.0
MPCDHE90/250/300	300	250	R300	
MPCDHE90/250/400	400			
MPCDHE90/250/500	500			
MPCDHE90/250/600	600			
MPCDHE90/250/800	800			
MPCDHE90/250/1000	1000			
MPCDHE90/400/400	400	400	R300	3.0
MPCDHE90/400/500	500			
MPCDHE90/400/600	600			
MPCDHE90/400/800	800			
MPCDHE90/400/1000	1000			

Example: MPCDHT/150/200

METAL PERFORATORS
 CABLE DUCT HORIZONTAL TEE
 150H X 200W X R300 X 2T

STRAIGHT CABLE DUCT

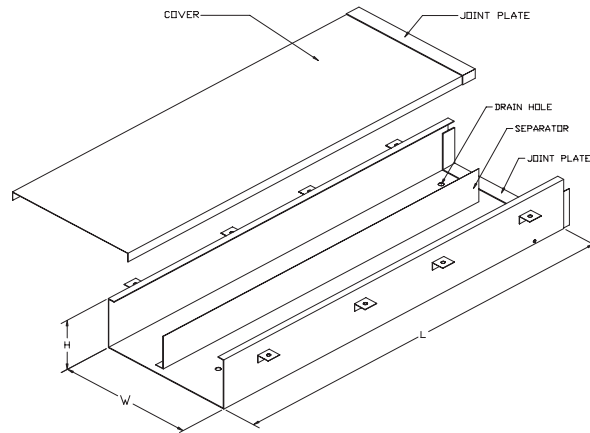

STANDARD DIMENSION					STANDARD DIMENSION				
PART NO	W (mm)	H (mm)	T (mm)	L (mm)	PART NO	W (mm)	H (mm)	T (mm)	L (mm)
MPSD/150/200	200	150	2.0	3000	-	-	250	3.0	3000
MPSD/150/300	300				MPSD/250/300	300			
MPSD/150/400	400				MPSD/250/400	400			
MPSD/150/500	500		3.0		MPSD/250/500	500			
MPSD/150/600	600				MPSD/250/600	600			
MPSD/150/800	800				MPSD/250/800	800			
MPSD/150/1000	1000		MPSD/250/1000	1000					

PART NO	W (mm)	H (mm)	T (mm)	L (mm)	PART NO	W (mm)	H (mm)	T (mm)	L (mm)
MPSD/200/200	200	200	2.0	3000	-	-	400	3.0	3000
MPSD/200/300	300				MPSD/400/400	400			
MPSD/200/400	400				MPSD/400/500	500			
MPSD/200/500	500		3.0		MPSD/400/600	600			
MPSD/200/600	600				MPSD/400/800	800			
MPSD/200/800	800				MPSD/400/1000	1000			
MPSD/200/1000	1000								

NOTE : Other sizes are available upon request

Standard Specifications:

- MATERIAL : Mild Steel / SS 304 / SS 316
- LENGTH : 3000 mm (± 6mm)
- THICKNESS : 2mm to 3mm
- FINISHING : HDG - ISO 1461 / BS 729 / ASTM A386
- FASTENERS : HDG, EZP, SS 304 & SS 316

REMARKS:

MP : METAL PERFORATED
SD : STRAIGHT CABLE DUCT

Example: MPSD/150/200
METAL PERFORATED
STRAIGHT CABLE DUCT
150H X 200W X 2T X 3000L

HORIZONTAL UNEQUAL CROSS

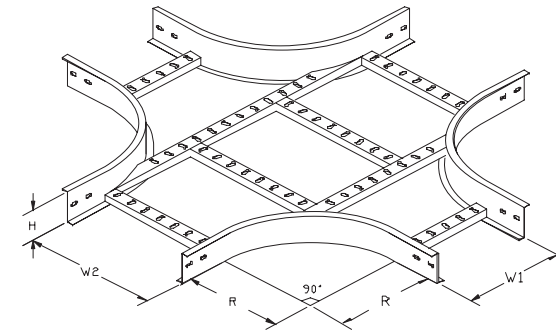

Z-TYPE	INWARD C	OUTWARD C	KABELRAX	STANDARD DIMENSION			
PART NO.	PART NO.	PART NO.	PART NO.	H(mm)	W1(mm)	W2(mm)	Radius
MPLZUC/100/20-15	MPLIUC/100/20-15	MPLOUC/100/20-15	MPLKUC/100/20-15	100	200	150	R300 to R900
MPLZUC/100/30-20	MPLIUC/100/30-20	MPLOUC/100/30-20	MPLKUC/100/30-20		300	200	
MPLZUC/100/45-30	MPLIUC/100/45-30	MPLOUC/100/45-30	MPLKUC/100/45-30		450	300	
MPLZUC/100/60-45	MPLIUC/100/60-45	MPLOUC/100/60-45	MPLKUC/100/60-45		600	450	
MPLZUC/100/75-60	MPLIUC/100/75-60	MPLOUC/100/75-60	MPLKUC/100/75-60		750	600	
MPLZUC/100/90-75	MPLIUC/100/90-75	MPLOUC/100/90-75	MPLKUC/100/90-75	900	750		
MPLZUC/125/20-15	MPLIUC/125/20-15	MPLOUC/125/20-15	MPLKUC/125/20-15	125	200	150	R300 to R900
MPLZUC/125/30-20	MPLIUC/125/30-20	MPLOUC/125/30-20	MPLKUC/125/30-20		300	200	
MPLZUC/125/45-30	MPLIUC/125/45-30	MPLOUC/125/45-30	MPLKUC/125/45-30		450	300	
MPLZUC/125/60-45	MPLIUC/125/60-45	MPLOUC/125/60-45	MPLKUC/125/60-45		600	450	
MPLZUC/125/75-60	MPLIUC/125/75-60	MPLOUC/125/75-60	MPLKUC/125/75-60		750	600	
MPLZUC/125/90-75	MPLIUC/125/90-75	MPLOUC/125/90-75	MPLKUC/125/90-75	900	750		
MPLZUC/150/20-15	MPLIUC/150/20-15	MPLOUC/150/20-15	MPLKUC/150/20-15	150	200	150	R300 to R900
MPLZUC/150/30-20	MPLIUC/150/30-20	MPLOUC/150/30-20	MPLKUC/150/30-20		300	200	
MPLZUC/150/45-30	MPLIUC/150/45-30	MPLOUC/150/45-30	MPLKUC/150/45-30		450	300	
MPLZUC/150/60-45	MPLIUC/150/60-45	MPLOUC/150/60-45	MPLKUC/150/60-45		600	450	
MPLZUC/150/75-60	MPLIUC/150/75-60	MPLOUC/150/75-60	MPLKUC/150/75-60		750	600	
MPLZUC/150/90-75	MPLIUC/150/90-75	MPLOUC/150/90-75	MPLKUC/150/90-75	900	750		

NOTE : Other sizes are available upon request

Standard Specifications:

- TYPE : Z - Type, Outward C, Inward C and Kabelrax
- MATERIAL : Mild Steel / SS 304 / SS 316
- THICKNESS : 1.5mm to 3.0mm
- RADIUS : R300mm to R900mm (Standard R300mm)
- FINISHING : HDG Accordance to ISO 1461 / BS 729 / ASTM A386 for Mild Steel
- FASTENERS : HDG, EZP, SS 304 & SS 316

REMARKS :

MP : METAL PERFORATORS
L : LADDER
UC : UNEQUAL CROSS
Z : Z -TYPE
K : KABELRAX
O : OUTWARD C
I : INWARD C

EXAMPLE : MPLZUC/100/20-15
METAL PERFORATORS
Z TYPE LADDER
UNEQUAL CROSS 100H X 200W-150W

INTERNAL VERTICAL RISER 90°

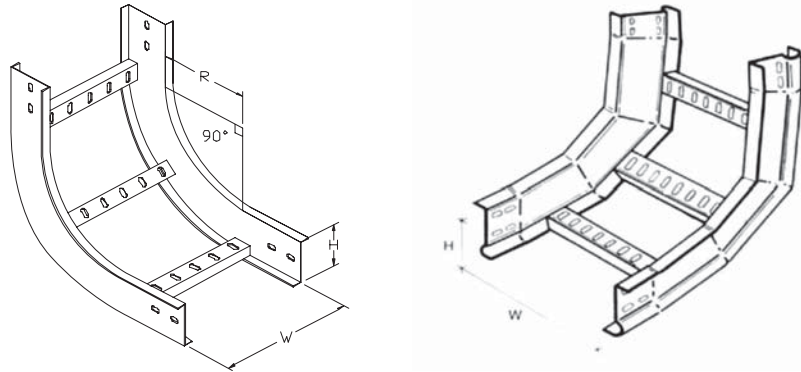

CABLE DUCTING

Z-TYPE		INWARD C		OUTWARD C		KABELRAX		STANDARD DIMENSION		
PART NO.	PART NO.	PART NO.	PART NO.	PART NO.	PART NO.	H(mm)	W(mm)	Radius		
MPLZIR90/100/15	MPLIIR90/100/15	MPLOIR90/100/15	MPLKIR90/100/15	100	R300 to R900	150	900			
MPLZIR90/100/20	MPLIIR90/100/20	MPLOIR90/100/20	MPLKIR90/100/20			200				
MPLZIR90/100/30	MPLIIR90/100/30	MPLOIR90/100/30	MPLKIR90/100/30			300				
MPLZIR90/100/45	MPLIIR90/100/45	MPLOIR90/100/45	MPLKIR90/100/45			450				
MPLZIR90/100/60	MPLIIR90/100/60	MPLOIR90/100/60	MPLKIR90/100/60			600				
MPLZIR90/100/75	MPLIIR90/100/75	MPLOIR90/100/75	MPLKIR90/100/75			750				
MPLZIR90/100/90	MPLIIR90/100/90	MPLOIR90/100/90	MPLKIR90/100/90	900						
MPLZIR90/125/15	MPLIIR90/125/15	MPLOIR90/125/15	MPLKIR90/125/15	125	R300 to R900	150	900			
MPLZIR90/125/20	MPLIIR90/125/20	MPLOIR90/125/20	MPLKIR90/125/20			200				
MPLZIR90/125/30	MPLIIR90/125/30	MPLOIR90/125/30	MPLKIR90/125/30			300				
MPLZIR90/125/45	MPLIIR90/125/45	MPLOIR90/125/45	MPLKIR90/125/45			450				
MPLZIR90/125/60	MPLIIR90/125/60	MPLOIR90/125/60	MPLKIR90/125/60			600				
MPLZIR90/125/75	MPLIIR90/125/75	MPLOIR90/125/75	MPLKIR90/125/75			750				
MPLZIR90/125/90	MPLIIR90/125/90	MPLOIR90/125/90	MPLKIR90/125/90	900						
MPLZIR90/150/15	MPLIIR90/150/15	MPLOIR90/150/15	MPLKIR90/150/15	150	R300 to R900	150	900			
MPLZIR90/150/20	MPLIIR90/150/20	MPLOIR90/150/20	MPLKIR90/150/20			200				
MPLZIR90/150/30	MPLIIR90/150/30	MPLOIR90/150/30	MPLKIR90/150/30			300				
MPLZIR90/150/45	MPLIIR90/150/45	MPLOIR90/150/45	MPLKIR90/150/45			450				
MPLZIR90/150/60	MPLIIR90/150/60	MPLOIR90/150/60	MPLKIR90/150/60			600				
MPLZIR90/150/75	MPLIIR90/150/75	MPLOIR90/150/75	MPLKIR90/150/75			750				
MPLZIR90/150/90	MPLIIR90/150/90	MPLOIR90/150/90	MPLKIR90/150/90	900						

NOTE : Other sizes are available upon request

Standard Specifications:

1. TYPE : Z - Type, Outward C, Inward C and Kabelrax
2. MATERIAL : Mild Steel / SS 304 / SS 316
3. THICKNESS : 1.5mm to 3.0mm
4. RADIUS : R300mm to R900mm (Standard R300mm)
5. FINISHING : HDG Accordance to ISO 1461 / BS 729 / ASTM A386 for Mild Steel
6. FASTENERS : HDG, EZP, SS 304 & SS 316

REMARKS :

- MP : METAL PERFORATORS
- L : LADDER
- IR90 : INTERNAL RISER 90°
- Z : Z-TYPE
- K : KABELRAX
- O : OUTWARD C
- I : INWARD C

EXAMPLE : MPLZER90/100/15
 METAL PERFORATORS
 Z TYPE LADDER
 INTERNAL RISER 90° 100H X 150W

EXTERNAL RISER 90°

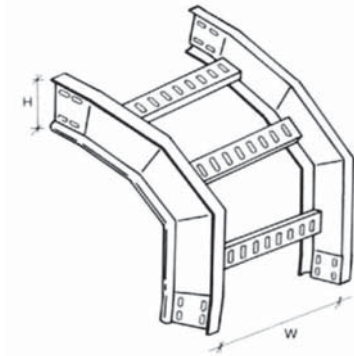
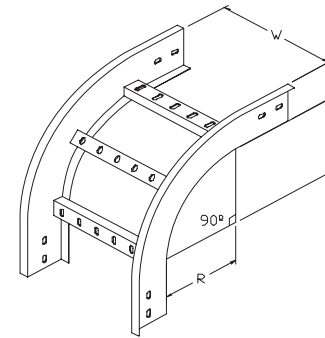

Z-TYPE		INWARD C		OUTWARD C		KABELRAX		STANDARD DIMENSION		
PART NO.	PART NO.	PART NO.	PART NO.	PART NO.	PART NO.	H(mm)	W(mm)	Radius		
MPLZER90/100/15	MPLIER90/100/15	MPLOER90/100/15	MPLKER90/100/15	100	R300 to R900	150				
MPLZER90/100/20	MPLIER90/100/20	MPLOER90/100/20	MPLKER90/100/20			200				
MPLZER90/100/30	MPLIER90/100/30	MPLOER90/100/30	MPLKER90/100/30			300				
MPLZER90/100/45	MPLIER90/100/45	MPLOER90/100/45	MPLKER90/100/45			450				
MPLZER90/100/60	MPLIER90/100/60	MPLOER90/100/60	MPLKER90/100/60			600				
MPLZER90/100/75	MPLIER90/100/75	MPLOER90/100/75	MPLKER90/100/75			750				
MPLZER90/100/90	MPLIER90/100/90	MPLOER90/100/90	MPLKER90/100/90			900				
MPLZER90/125/15	MPLIER90/125/15	MPLOER90/125/15	MPLKER90/125/15			125				
MPLZER90/125/20	MPLIER90/125/20	MPLOER90/125/20	MPLKER90/125/20	200						
MPLZER90/125/30	MPLIER90/125/30	MPLOER90/125/30	MPLKER90/125/30	300						
MPLZER90/125/45	MPLIER90/125/45	MPLOER90/125/45	MPLKER90/125/45	450						
MPLZER90/125/60	MPLIER90/125/60	MPLOER90/125/60	MPLKER90/125/60	600						
MPLZER90/125/75	MPLIER90/125/75	MPLOER90/125/75	MPLKER90/125/75	750						
MPLZER90/125/90	MPLIER90/125/90	MPLOER90/125/90	MPLKER90/125/90	900						
MPLZER90/150/15	MPLIER90/150/15	MPLOER90/150/15	MPLKER90/150/15	150	R300 to R900		150			
MPLZER90/150/20	MPLIER90/150/20	MPLOER90/150/20	MPLKER90/150/20			200				
MPLZER90/150/30	MPLIER90/150/30	MPLOER90/150/30	MPLKER90/150/30			300				
MPLZER90/150/45	MPLIER90/150/45	MPLOER90/150/45	MPLKER90/150/45			450				
MPLZER90/150/60	MPLIER90/150/60	MPLOER90/150/60	MPLKER90/150/60			600				
MPLZER90/150/75	MPLIER90/150/75	MPLOER90/150/75	MPLKER90/150/75			750				
MPLZER90/150/90	MPLIER90/150/90	MPLOER90/150/90	MPLKER90/150/90			900				

NOTE : Other sizes are available upon request

Standard Specifications:

1. TYPE : Z - Type, Outward C, Inward C and Kabelrax
2. MATERIAL : Mild Steel / SS 304 / SS 316
3. THICKNESS : 1.5mm to 3.0mm
4. RADIUS : R300mm to R900mm (Standard R300mm)
5. FINISHING : HDG - ISO 1461 / BS 729 / ASTM A386
6. FASTENERS : HDG, EZP, SS 304 & SS 316

REMARKS :

MP : METAL PERFORATORS
 L : LADDER
 ER90 : EXTERNAL RISER 90°
 Z : Z -TYPE
 K : KABELRAX
 O : OUTWARD C
 I : INWARD C

EXAMPLE : MPLZER90/100/15
 METAL PERFORATORS
 Z TYPE LADDER
 EXTERNAL RISER 90° 100H X 150W

LEFT REDUCER

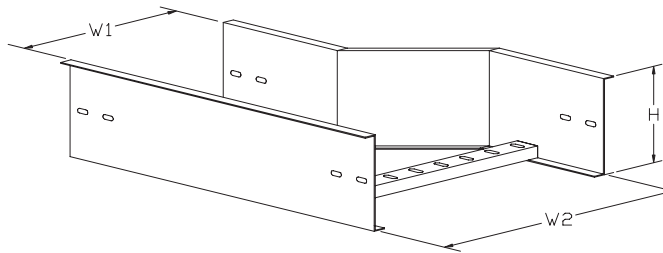

Z-TYPE				STANDARD DIMENSION		
PART NO.	INWARD C PART NO.	OUTWARD C PART NO.	KABELRAX PART NO.	H(mm)	W1(mm)	W2(mm)
MPLZLR/100/15-200	MPLILR/100/15-20	MPLOLR/100/15-20	MPLKLR/100/15-20	100	150	200
MPLZLR/100/20-30	MPLILR/100/20-30	MPLOLR/100/20-30	MPLKLR/100/20-30		200	300
MPLZLR/100/30-45	MPLILR/100/30-45	MPLOLR/100/30-45	MPLKLR/100/30-45		300	450
MPLZLR/100/45-60	MPLILR/100/45-60	MPLOLR/100/45-60	MPLKLR/100/45-60		450	600
MPLZLR/100/60-75	MPLILR/100/60-75	MPLOLR/100/60-75	MPLKLR/100/60-75		600	750
MPLZLR/100/75-90	MPLILR/100/75-90	MPLOLR/100/75-90	MPLKLR/100/75-90	750	900	
MPLZLR/125/15-200	MPLILR/125/15-20	MPLOLR/125/15-20	MPLKLR/125/15-20	125	150	200
MPLZLR/125/20-30	MPLILR/125/20-30	MPLOLR/125/20-30	MPLKLR/125/20-30		200	300
MPLZLR/125/30-45	MPLILR/125/30-45	MPLOLR/125/30-45	MPLKLR/125/30-45		300	450
MPLZLR/125/45-60	MPLILR/125/45-60	MPLOLR/125/45-60	MPLKLR/125/45-60		450	600
MPLZLR/125/60-75	MPLILR/125/60-75	MPLOLR/125/60-75	MPLKLR/125/60-75		600	750
MPLZLR/125/75-90	MPLILR/125/75-90	MPLOLR/125/75-90	MPLKLR/125/75-90	750	900	
MPLZLR/150/15-200	MPLILR/150/15-20	MPLOLR/150/15-20	MPLKLR/150/15-20	150	150	200
MPLZLR/150/20-30	MPLILR/150/20-30	MPLOLR/150/20-30	MPLKLR/150/20-30		200	300
MPLZLR/150/30-45	MPLILR/150/30-45	MPLOLR/150/30-45	MPLKLR/150/30-45		300	450
MPLZLR/150/45-60	MPLILR/150/45-60	MPLOLR/150/45-60	MPLKLR/150/45-60		450	600
MPLZLR/150/60-75	MPLILR/150/60-75	MPLOLR/150/60-75	MPLKLR/150/60-75		600	750
MPLZLR/150/75-90	MPLILR/150/75-90	MPLOLR/150/75-90	MPLKLR/150/75-90	750	900	

NOTE : Other sizes are available upon request

Standard Specifications:

1. TYPE : Z - Type, Outward C, Inward C and Kabelrax
2. MATERIAL : Mild Steel / SS 304 / SS 316
3. THICKNESS : 1.5mm to 3.0mm
4. RADIUS : -
5. FINISHING : HDG Accordance to ISO 1461 / BS 729 / ASTM A386 for Mild Steel
6. FASTENERS : HDG, E郑, SS 304 & SS 316

REMARKS :

MP : METAL PERFORATORS
 L : LADDER
 LR : LEFT REDUCER
 Z : Z-TYPE
 K : KABELRAX
 O : OUTWARD C
 I : INWARD C

EXAMPLE : MPLZLR/100/15-20
 METAL PERFORATORS
 Z TYPE LADDER
 LEFT REDUCER 100H X 150W-200W

TRUNKING - OUTSIDE RISER 90°

TRUNKING - INSIDE RISER 90°

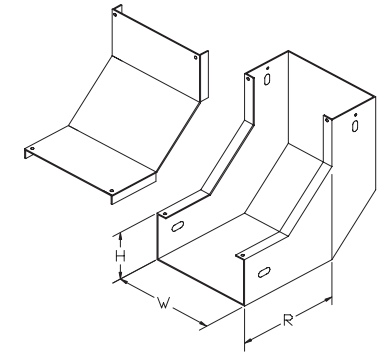
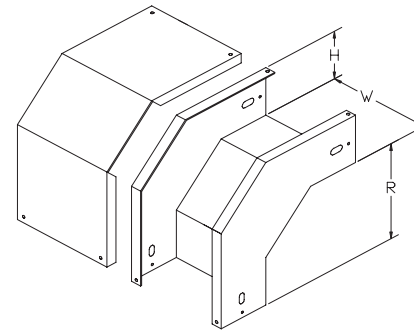

STANDARD DIMENSION				
PART NO	W 1(mm)	H (mm)	R (mm)	T (mm)
MPTGOR90/50/50	50	50	R200	1.0 to 2.0
MPTGOR90/50/75	75			
MPTGOR90/50/100	100			
MPTGOR90/50/150	150			
MPTGOR90/50/200	200			
MPTGOR90/75/300	300	75		
MPTGOR90/75/75	75			
MPTGOR90/75/100	100			
MPTGOR90/75/150	150			
MPTGOR90/75/200	200			
MPTGOR90/75/250	250	100		
MPTGOR90/100/100	100			
MPTGOR90/100/150	150			
MPTGOR90/100/200	200			
MPTGOR90/100/250	250			
MPTGOR90/100/300	300	150		
MPTGOR90/150/150	150			
MPTGOR90/150/200	200			
MPTGOR90/150/250	250			
MPTGOR90/150/300	300			

NOTE : Other sizes are available upon request

Standard Specifications:

1. MATERIAL : Mild Steel / SS 304 / SS 316
2. FINISHING : HDG Accordance to ISO 1461 / BS 729 / ASTM A386 / Epoxy Powder Coating
3. FASTENERS : HDG, E郑, SS 304 & SS 316

REMARKS:

MP : METAL PERFORATORS
 TG : TRUNKING
 IR90 : INSIDE RISER 90°
 OR90 : OUTSIDE RISER 90°

EXAMPLE 1 : MPTGOR90/50/150
 METAL PERFORATORS
 TRUNKING - OUTSIDE RISER 90°
 50H X 150W

EXAMPLE 2 : MPTGIR90/50/150
 METAL PERFORATORS
 TRUNKING - INSIDE RISER 90°
 50H X 150W

TRUNKING - HORIZONTAL CROSS

TRUNKING - REDUCER LEFT/RIGHT

RIGHT REDUCER

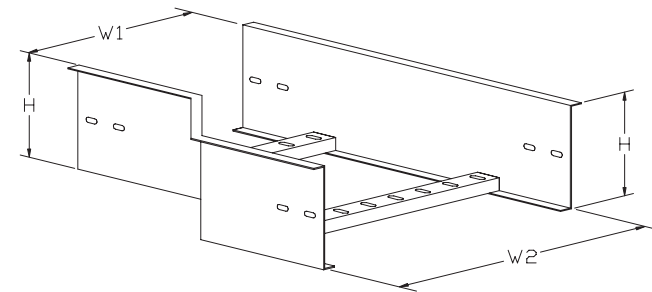
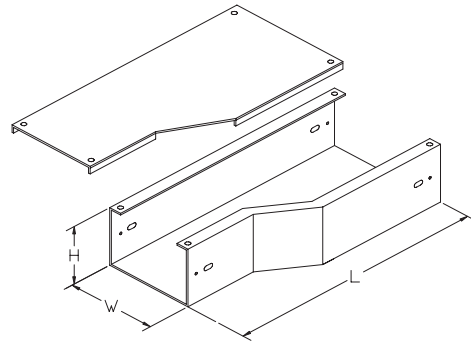
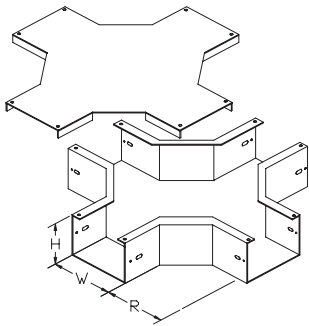

STANDARD DIMENSION				
PART NO	W (mm)	H (mm)	R (mm)	T (mm)
MPTGHX/50/50	50	50	R200	1.0 up to 2.0
MPTGHX/50/75	75			
MPTGHX/50/100	100			
MPTGHX/50/150	150			
MPTGHX/50/200	200			
MPTGHX/75/75	75	75		
MPTGHX/75/100	100			
MPTGHX/75/150	150			
MPTGHX/75/200	200			
MPTGHX/75/250	250	100		
MPTGHX/75/300	300			
MPTGHX/100/100	100			
MPTGHX/100/150	150			
MPTGHX/100/200	200	150		
MPTGHX/100/250	250			
MPTGHX/100/300	300			
MPTGHX/150/150	150			
MPTGHX/150/200	200			
MPTGHX/150/250	250			
MPTGHX/150/300	300			

NOTE : Other sizes are available upon request

STANDARD DIMENSION				
PART NO	W (mm)	H (mm)	L (mm)	T (mm)
MPTGRR/L/50/75-50	75-50	50	450	1.0 up to 2.0
MPTGRR/L/50/100-75	100-75			
MPTGRR/L/50/150-100	150-100			
MPTGRR/L/50/200-150	200-150			
MPTGRR/L/75/100-75	100-75	75		
MPTGRR/L/75/150-100	150-100			
MPTGRR/L/75/200-150	200-150			
MPTGRR/L/75/250-200	250-200			
MPTGRR/L/75/300-250	300-250	100		
MPTGRR/L/100/150-100	150-100			
MPTGRR/L/100/200-150	200-150			
MPTGRR/L/100/250-200	250-200			
MPTGRR/L/100/300-250	300-250	150		
MPTGRR/L/150/200-150	200-150			
MPTGRR/L/150/250-200	250-200			
MPTGRR/L/150/300-250	300-250			

Standard Specifications:

- MATERIAL : Mild Steel / SS 304 / SS 316
- FINISHING : HDG Accordance to ISO 1461 / BS 729 / ASTM A386 / Epoxy Powder Coating
- FASTENERS : HDG, EZP, SS 304 & SS 316

REMARKS:

MP : METAL PERFORATORS HX : HORIZONTAL CROSS
 TG : TRUNKING RL : REDUCER LEFT RR : REDUCER RIGHT

EXAMPLE 1 : MPTGHX/50/150

METAL PERFORATORS
 TRUNKING - HORIZONTAL CROSS
 50H X 150W

EXAMPLE 2 : MPTGRL/50/150-100

METAL PERFORATORS
 TRUNKING - REDUCER LEFT
 50H X 150W-100W

Z-TYPE	INWARD C	OUTWARD C	KABELRAX	STANDARD DIMENSION		
PART NO.	PART NO.	PART NO.	PART NO.	H(mm)	W1(mm)	W2(mm)
MPLZRR/100/15-200	MPLIRR/100/15-20	MPLORR/100/15-20	MPLKRR/100/15-20	100	150	200
MPLZRR/100/20-30	MPLIRR/100/20-30	MPLORR/100/20-30	MPLKRR/100/20-30		200	300
MPLZRR/100/30-45	MPLIRR/100/30-45	MPLORR/100/30-45	MPLKRR/100/30-45		300	450
MPLZRR/100/45-60	MPLIRR/100/45-60	MPLORR/100/45-60	MPLKRR/100/45-60		450	600
MPLZRR/100/60-75	MPLIRR/100/60-75	MPLORR/100/60-75	MPLKRR/100/60-75		600	750
MPLZRR/100/75-90	MPLIRR/100/75-90	MPLORR/100/75-90	MPLKRR/100/75-90	750	900	

MPLZRR/125/15-200	MPLIRR/125/15-20	MPLORR/125/15-20	MPLKRR/125/15-20	125	150	200
MPLZRR/125/20-30	MPLIRR/125/20-30	MPLORR/125/20-30	MPLKRR/125/20-30		200	300
MPLZRR/125/30-45	MPLIRR/125/30-45	MPLORR/125/30-45	MPLKRR/125/30-45		300	450
MPLZRR/125/45-60	MPLIRR/125/45-60	MPLORR/125/45-60	MPLKRR/125/45-60		450	600
MPLZRR/125/60-75	MPLIRR/125/60-75	MPLORR/125/60-75	MPLKRR/125/60-75		600	750
MPLZRR/125/75-90	MPLIRR/125/75-90	MPLORR/125/75-90	MPLKRR/125/75-90	750	900	

MPLZRR/150/15-200	MPLIRR/150/15-20	MPLORR/150/15-20	MPLKRR/150/15-20	150	150	200
MPLZRR/150/20-30	MPLIRR/150/20-30	MPLORR/150/20-30	MPLKRR/150/20-30		200	300
MPLZRR/150/30-45	MPLIRR/150/30-45	MPLORR/150/30-45	MPLKRR/150/30-45		300	450
MPLZRR/150/45-60	MPLIRR/150/45-60	MPLORR/150/45-60	MPLKRR/150/45-60		450	600
MPLZRR/150/60-75	MPLIRR/150/60-75	MPLORR/150/60-75	MPLKRR/150/60-75		600	750
MPLZRR/150/75-90	MPLIRR/150/75-90	MPLORR/150/75-90	MPLKRR/150/75-90	750	900	

NOTE : Other sizes are available upon request

Standard Specifications:

- TYPE : Z - Type, Outward C, Inward C and Kabelrax
- MATERIAL : Mild Steel / SS 304 / SS 316
- THICKNESS : 1.5mm to 3.0mm
- RADIUS : -
- FINISHING : HDG Accordance to ISO 1461 / BS 729 / ASTM A386 for Mild Steel
- FASTENERS : HDG, EZP, SS 304 & SS 316

REMARKS :

MP : METAL PERFORATORS **EXAMPLE : MPLZRR/100/15-20**
 L : LADDER METAL PERFORATORS
 RR : RIGHT REDUCER Z TYPE LADDER
 Z : Z-TYPE RIGHT REDUCER 100H X 150W-200W
 K : KABELRAX
 O : OUTWARD C
 I : INWARD C

STRAIGHT REDUCER

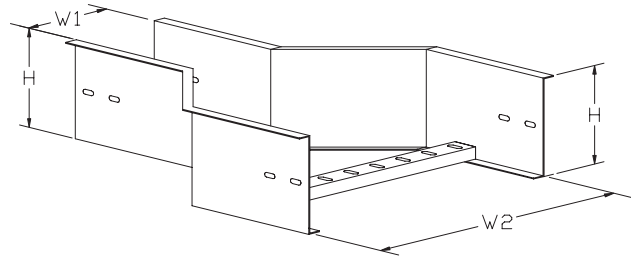

Z-TYPE	INWARD C	OUTWARD C	KABELRAX	STANDARD DIMENSION		
PART NO.	PART NO.	PART NO.	PART NO.	H(mm)	W1(mm)	W2(mm)
MPLZSR/100/15-20	MPLISR/100/15-20	MPLOSR/100/15-20	MPLKSR/100/15-20	100	150	200
MPLZSR/100/20-30	MPLISR/100/20-30	MPLOSR/100/20-30	MPLKSR/100/20-30		200	300
MPLZSR/100/30-45	MPLISR/100/30-45	MPLOSR/100/30-45	MPLKSR/100/30-45		300	450
MPLZSR/100/45-60	MPLISR/100/45-60	MPLOSR/100/45-60	MPLKSR/100/45-60		450	600
MPLZSR/100/60-75	MPLISR/100/60-75	MPLOSR/100/60-75	MPLKSR/100/60-75		600	750
MPLZSR/100/75-90	MPLISR/100/75-90	MPLOSR/100/75-90	MPLKSR/100/75-90	750	900	
MPLZSR/125/15-20	MPLISR/125/15-20	MPLOSR/125/15-20	MPLKSR/125/15-20	125	150	200
MPLZSR/125/20-30	MPLISR/125/20-30	MPLOSR/125/20-30	MPLKSR/125/20-30		200	300
MPLZSR/125/30-45	MPLISR/125/30-45	MPLOSR/125/30-45	MPLKSR/125/30-45		300	450
MPLZSR/125/45-60	MPLISR/125/45-60	MPLOSR/125/45-60	MPLKSR/125/45-60		450	600
MPLZSR/125/60-75	MPLISR/125/60-75	MPLOSR/125/60-75	MPLKSR/125/60-75		600	750
MPLZSR/125/75-90	MPLISR/125/75-90	MPLOSR/125/75-90	MPLKSR/125/75-90	750	900	
MPLZSR/150/15-20	MPLISR/150/15-20	MPLOSR/150/15-20	MPLKSR/150/15-20	150	150	200
MPLZSR/150/20-30	MPLISR/150/20-30	MPLOSR/150/20-30	MPLKSR/150/20-30		200	300
MPLZSR/150/30-45	MPLISR/150/30-45	MPLOSR/150/30-45	MPLKSR/150/30-45		300	450
MPLZSR/150/45-60	MPLISR/150/45-60	MPLOSR/150/45-60	MPLKSR/150/45-60		450	600
MPLZSR/150/60-75	MPLISR/150/60-75	MPLOSR/150/60-75	MPLKSR/150/60-75		600	750
MPLZSR/150/75-90	MPLISR/150/75-90	MPLOSR/150/75-90	MPLKSR/150/75-90	750	900	

NOTE : Other sizes are available upon request

Standard Specifications:

1. TYPE : Z - Type, Outward C, Inward C and Kabelrax
2. MATERIAL : Mild Steel / SS 304 / SS 316
3. THICKNESS : 1.5mm to 3.0mm
4. RADIUS : -
5. FINISHING : HDG Accordance to ISO 1461 / BS 729 / ASTM A386 for Mild Steel
6. FASTENERS : HDG, EZP, SS 304 & SS 316

REMARKS :

MP : METAL PERFORATORS
 Z : Z-TYPE
 SR : STRAIGHT REDUCER
 I : INWARD C
 O : OUTWARD C
 K : KABELRAX

EXAMPLE : MPLZSR/100/15-20
 METAL PERFORATORS
 Z TYPE LADDER
 STRAIGHT REDUCER 100H X 150W-200W

TRUNKING - HORIZONTAL ELBOW 90°

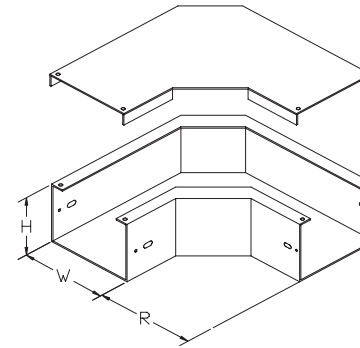

PART NO	STANDARD DIMENSION			
	W 1(mm)	H (mm)	R (mm)	T (mm)
MPTGEL90/50/50	50	50	R200	1.0 up to 2.0
MPTGEL90/50/75	75			
MPTGEL90/50/100	100			
MPTGEL90/50/150	150			
MPTGEL90/50/200	200			
MPTGEL90/75/75	75	75		
MPTGEL90/75/100	100			
MPTGEL90/75/150	150			
MPTGEL90/75/200	200			
MPTGEL90/75/250	250			
MPTGEL90/75/300	300	100		
MPTGEL90/100/100	100			
MPTGEL90/100/150	150			
MPTGEL90/100/200	200			
MPTGEL90/100/250	250			
MPTGEL90/100/300	300	150		
MPTGEL90/150/150	150			
MPTGEL90/150/200	200			
MPTGEL90/150/250	250			
MPTGEL90/150/300	300			

NOTE : Other sizes are available upon request

Standard Specifications:

1. MATERIAL : Mild Steel / SS 304 / SS 316
2. FINISHING : HDG Accordance to ISO 1461 / BS 729 / ASTM A386 / Epoxy Powder Coating
3. FASTENERS : HDG, EZP, SS 304 & SS 316

REMARKS

MP : METAL PERFORATORS
 EL90 : HORIZONTAL ELBOW 90°
 TG : TRUNKING
 HT : HORIZONTAL TEE

EXAMPLE 1 : MPTGEL90/50/150
 METAL PERFORATORS
 TRUNKING - ELBOW 90°
 50H X 150W

TRUNKING - HORIZONTAL TEE

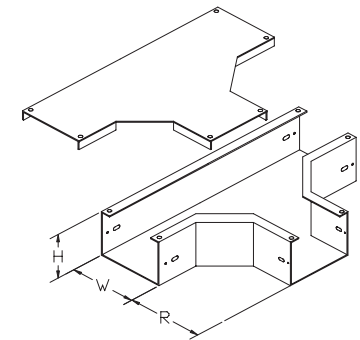

PART NO	STANDARD DIMENSION			
	W (mm)	H (mm)	R (mm)	T (mm)
MPTGHT/50/50	50	50	R200	1.0 up to 2.0
MPTGHT/50/75	75			
MPTGHT/50/100	100			
MPTGHT/50/150	150			
MPTGHT/50/200	200			
MPTGHT/75/75	75	75		
MPTGHT/75/100	100			
MPTGHT/75/150	150			
MPTGHT/75/200	200			
MPTGHT/75/250	250			
MPTGHT/75/300	300	100		
MPTGHT/100/100	100			
MPTGHT/100/150	150			
MPTGHT/100/200	200			
MPTGHT/100/250	250			
MPTGHT/100/300	300	150		
MPTGHT/150/150	150			
MPTGHT/150/200	200			
MPTGHT/150/250	250			
MPTGHT/150/300	300			

EXAMPLE 2 : MPTGHT/50/150
 METAL PERFORATORS
 TRUNKING - HORIZONTAL TEE
 50H X 150W

STRAIGHT CABLE TRUNKING

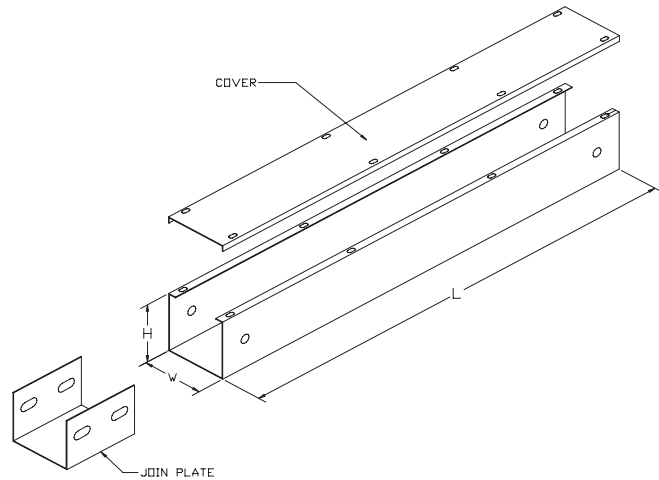

STANDARD DIMENSION				
PART NO.	W (mm)	H (mm)	T (mm)	L (mm)
MPSTG/50/50	50	50	1.0 up to 2.0	2438
MPSTG/50/75	75			
MPSTG/50/100	100			
MPSTG/50/150	150			
MPSTG/50/200	200			
MPSTG/75/75	75	75		
MPSTG/75/100	100			
MPSTG/75/150	150			
MPSTG/75/200	200			
MPSTG/75/250	250			
MPSTG/75/300	300	100		
MPSTG/100/100	100			
MPSTG/100/150	150			
MPSTG/100/200	200			
MPSTG/100/250	250			
MPSTG/100/300	300	150		
MPSTG/150/150	150			
MPSTG/150/200	200			
MPSTG/150/250	250			
MPSTG/150/300	300			

NOTE : Other sizes are available upon request

Standard Specifications:

- MATERIAL : Mild Steel / SS 304 / SS 316
- STD LENGTH : 2438 mm (± 6mm)
- FINISHING : HDG Accordance to ISO 1461 / BS 729 / ASTM A386 / Epoxy Powder Coating
- FASTENERS : HDG, EZP, SS 304 & SS 316

REMARKS:

MP : METAL PERFORATORS
SCT : STRAIGHT TRUNKING

EXAMPLE : MPSTG/100/150

METAL PERFORATORS
STRAIGHT TRUNKING
100H X 150W

LADDER ACCESSORIES

KABELRAX TYPE JOINT

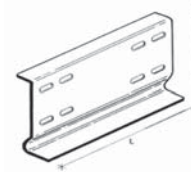

SPLICE PLATE

PART NO.	H (mm)	L (mm)
MPKSP100	100	210
MPKSP125	125	210
MPKSP150	150	210

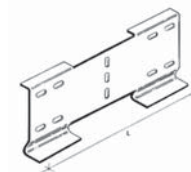

HORIZONTAL ADJUSTABLE SPLICE PLATE

PART NO.	H (mm)	L (mm)
MPKAP100	100	270
MPKAP125	125	270
MPKAP150	150	270

C & Z TYPE JOINT

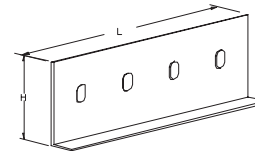

SPLICE PLATE

PART NO.	H (mm)	L (mm)
MPLADSP100	95	210
MPLADSP125	120	210
MPLADSP150	145	210

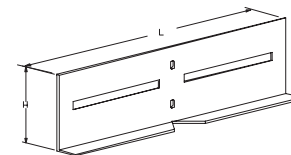

HORIZONTAL ADJUSTABLE SPLICE PLATE

PART NO.	H (mm)	L (mm)
MPLADHASP100	95	210
MPLADHASP125	120	210
MPLADHASP150	145	210



COVER CLIP

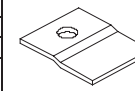

FLAT-TYPE
HOLD DOWN
CLAMP

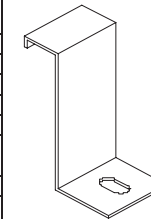

Z-TYPE HOLD
DOWN CLAMP



HEX BOLT

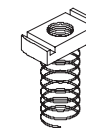

SPRING NUT

KABELRAX TYPE JOINT

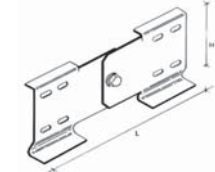

VERTICAL ADJUSTABLE SPLICE PLATE

PART NO.	H (mm)	L (mm)
MPKVP100	100	400
MPKVP125	125	400
MPKVP150	150	400

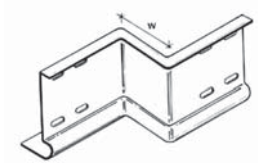

REDUCER PLATE

PART NO.	H (mm)	W (mm)
MPKRP/100/150	100	150
MPKRP/125/150	125	150
MPKRP/150/150	150	150

C & Z TYPE JOINT

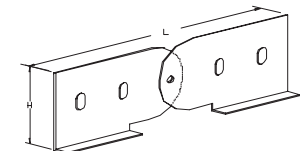

VERTICAL ADJUSTABLE SPLICE PLATE

PART NO.	H (mm)	L (mm)
MPLADVASP100	95	400
MPLADVASP125	120	400
MPLADVASP150	145	400

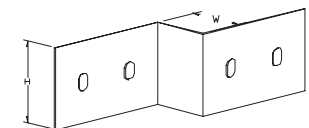

REDUCER PLATE

PART NO.	H (mm)	W (mm)
MPKRP100	95	150
MPKRP125	120	150
MPKRP150	145	150

GENERAL ACCESSORIES APPLICATION

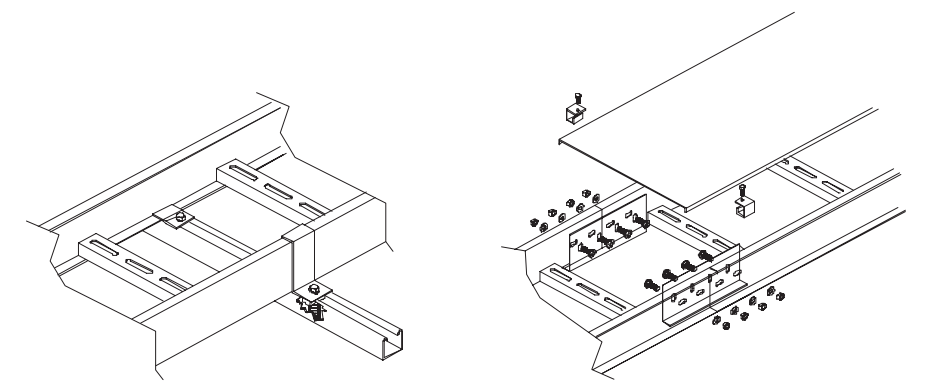
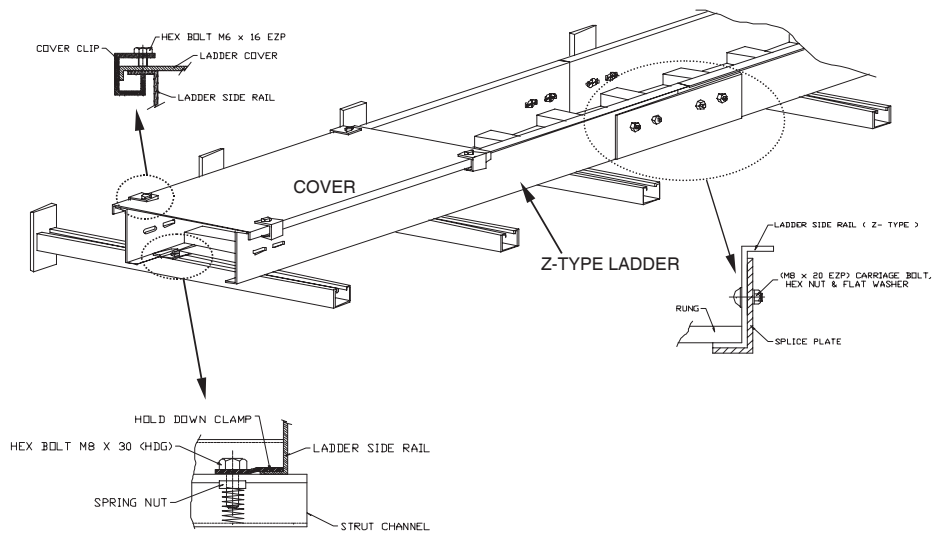

HOLD DOWN CLAMP

SPLICE PLATE - OUTWARD C TYPE



CABLE TRUNKING

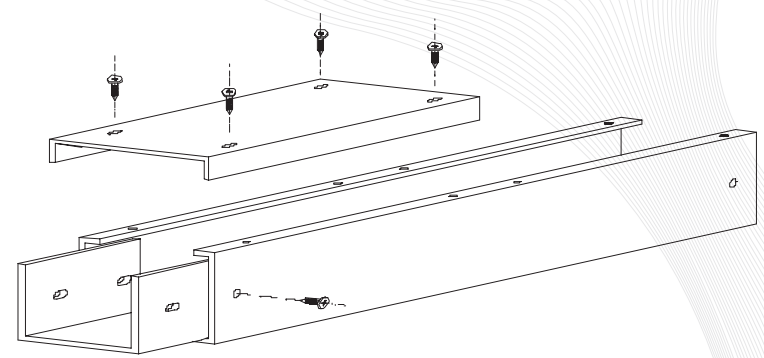

LOADING DATA FOR CABLE LADDER

CABLE LADDER (KABELRAX TYPE)

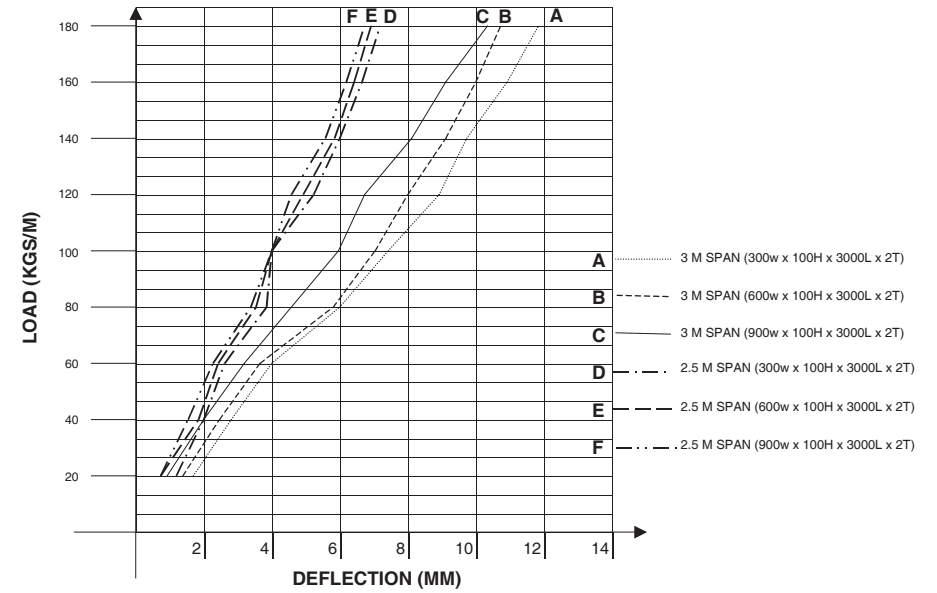

CABLE LADDER (Z-TYPE)

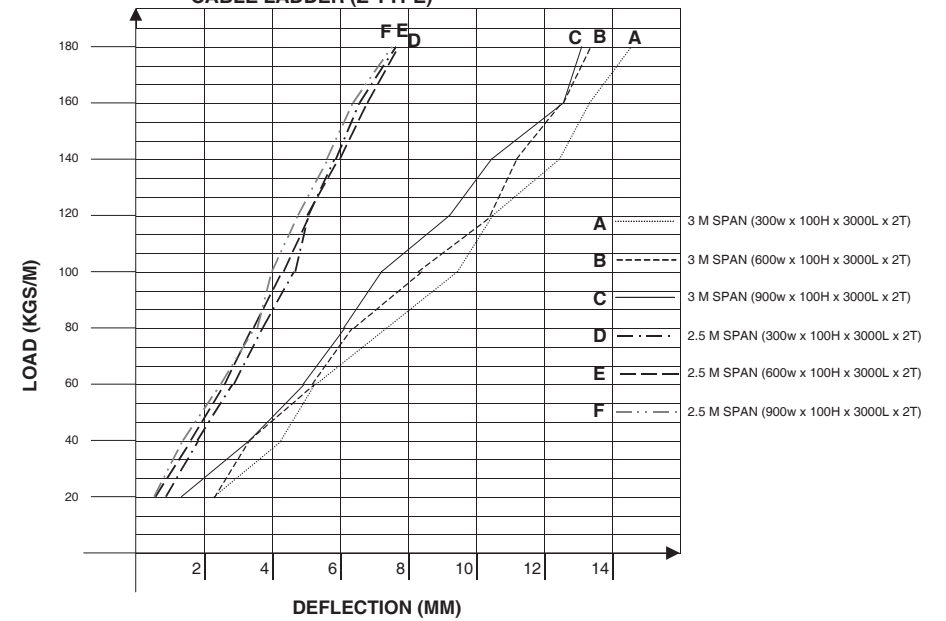

LOADING DATA FOR CABLE LADDER

CABLE LADDER (C -TYPE)

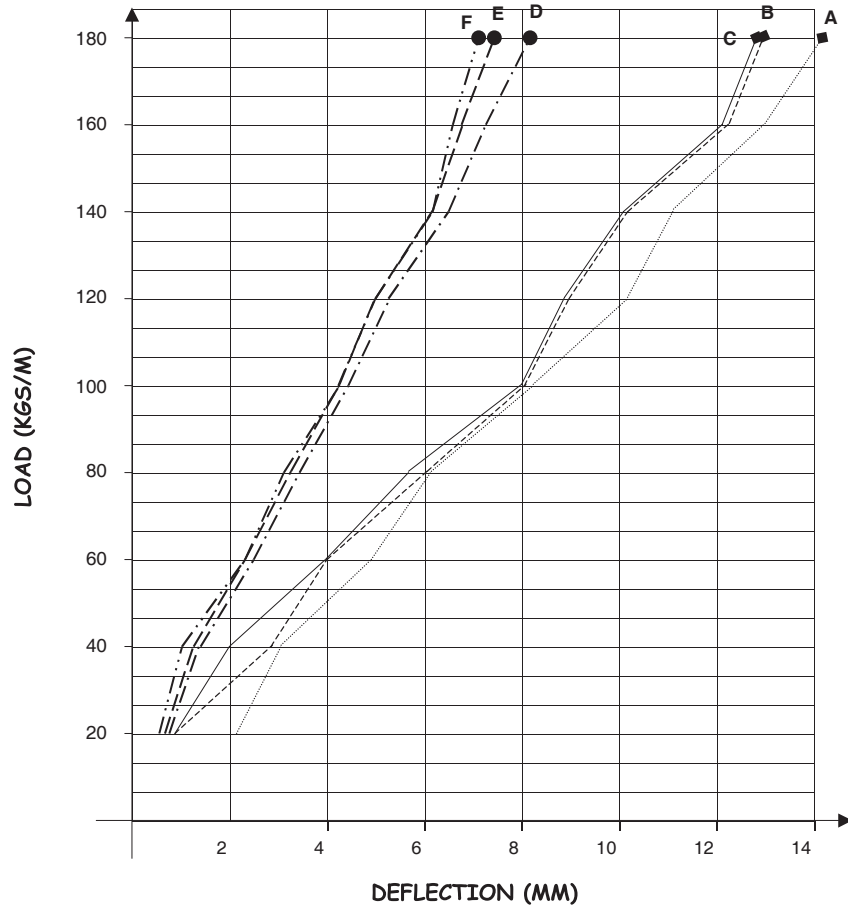

- A** 3 M SPAN (300w x 100H x 3000L x 2T)
- B** - - - - - 3 M SPAN (600w x 100H x 3000L x 2T)
- C** ——— 3 M SPAN (900w x 100H x 3000L x 2T)
- D** - · - · - 2.5 M SPAN (300w x 100H x 3000L x 2T)
- E** - - - - - 2.5 M SPAN (600w x 100H x 3000L x 2T)
- F** - · - · - 2.5 M SPAN (900w x 100H x 3000L x 2T)

LOADING DATA FOR WIRE MESH TRAY

WIRE MESH LOAD TEST

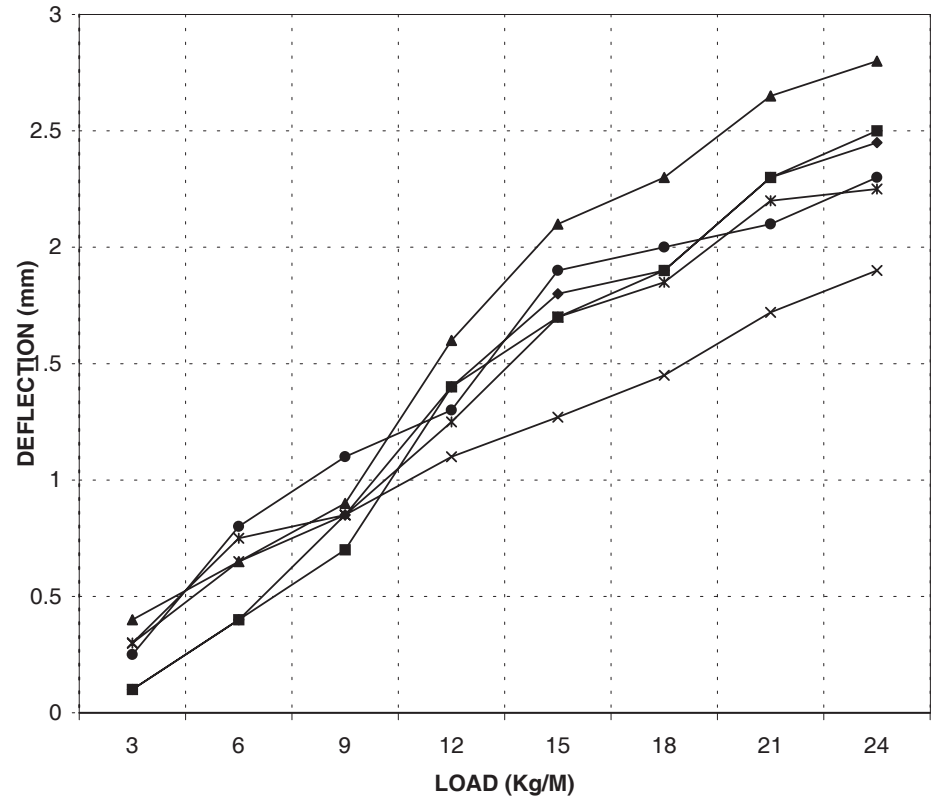

- ◆ 50W X 50H X 1.5M SPAN
- 100W X 50H X 1.5M SPAN
- ▲ 150W X 50H X 1.5M SPAN
- × 50W X 50H X 2M SPAN
- * 100W X 50H X 2M SPAN
- 150W X 50H X 2M SPAN

WIRE MESH TRAY - FITTINGS ACCESSORIS

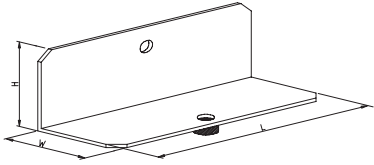

STRAIGHT CONNECTOR FOR 100W & ABOVE

PART NO	W(mm)	H(mm)	L(mm)
MPWMSC/100	40	45	150

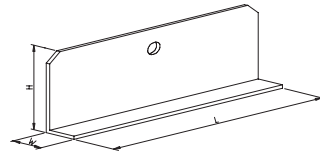

STRAIGHT CONNECTOR FOR 50W

PART NO	W(mm)	H(mm)	L(mm)
MPWMSC/50	20	45	100

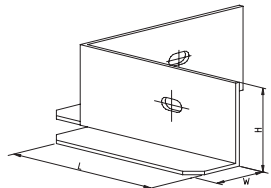

HORIZONTAL CONNECTOR

PART NO	W(mm)	H(mm)	L(mm)
MPWMTC/50	20	45	100
MPWMTC/100	40	45	100

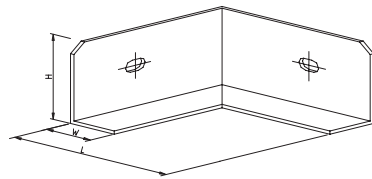

ELBOW CONNECTOR

PART NO	W(mm)	H(mm)	L(mm)
MPWMEC/50	20	45	100
MPWMEC/100	40	45	100

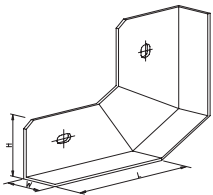

INSIDE RISER 90° CONNECTOR

PART NO	W(mm)	H(mm)	L(mm)
MPWMORC90/100	40	45	100

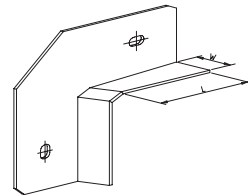

OUTSIDE RISER 90° CONNECTOR

PART NO	W(mm)	H(mm)	L(mm)
MPWMORC90/100	40	45	100

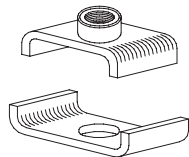

**STRAIGHT
CONNECTOR
PLATE**

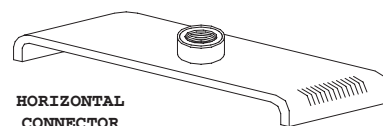

**HORIZONTAL
CONNECTOR
PLATE**

REMARKS

MP : METAL PERFORATOR
WM : WIRE MESH
SC : STRAIGHT CONNECTOR

EC : ELBOW CONNECTOR
TC : TEE CONNECTOR

EXAMPLE : MPWMSC/100

METAL PERFORATOR
WIRE MESH STRAIGHT CONNECTOR
100W



PERFORATED CABLE TRAY

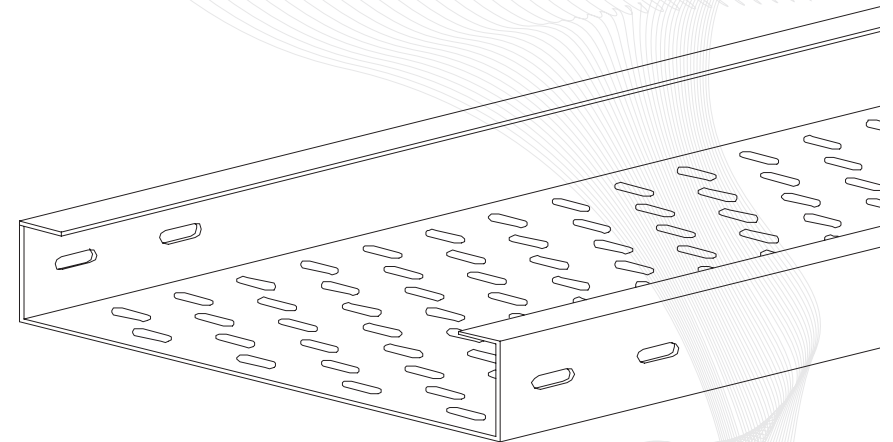

PERFORATED CABLE TRAY

PART NO	W(mm)	H(mm)	L (mm)	MATERIAL & FINISHING
MPSTUT/15/50	50	13 15 20 50	2438 3000	Mild Steel / SS 304 / SS 316 Thickness 1.5 mm HDG Accordance to ISO 1461 / BS 729 / ASTM A386
MPSCTA/15/100	75			
MPSCTA/15/100	100			
MPSCTA/15/150	150			
MPSCTA/15/200	200			

NOTE : Other sizes are available upon request

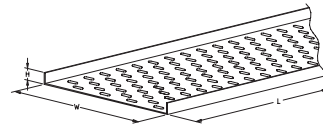

**U TYPE
(LIGHT DUTY)**

PART NO	W(mm)	H(mm)	L (mm)	MATERIAL & FINISHING
MPSTTH/50/75	75	50	2438 3000	Mild Steel / SS 304 / SS316 Thickness 1.5 to 2.0 mm HDG Accordance to ISO 1461 / BS 729 / ASTM A386
MPSTTH/50/100	100			
MPSTTH/50/150	150			
MPSTTH/50/200	200			
MPSTTH/75/100	100	75	2438 3000	
MPSTTH/75/150	150			
MPSTTH/75/200	200			
MPSTTH/75/300	300			
MPSTTH/100/100	100	100	2438 3000	
MPSTTH/100/150	150			
MPSTTH/100/200	200			
MPSTTH/100/300	300			

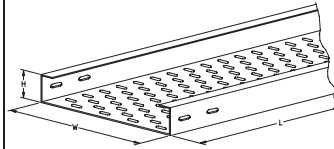

**TROUGH TYPE
(HEAVY DUTY)**

NOTE : Other sizes are available upon request

PART NO	W(mm)	H(mm)	L (mm)	MATERIAL & FINISHING
MPSTRF45/50/75	75	50	2438 3000	Mild Steel / SS 304 / SS316 Thickness 1.5 to 2.0 mm
MPSTRF45/50/100	100			
MPSTRF45/50/150	150			
MPSTRF45/50/300	300			
MPSTRF45/75/100	100	75	2438 3000	HDG Accordance to ISO 1461 / BS 729 / ASTM A386
MPSTRF45/75/150	150			
MPSTRF45/75/200	200			
MPSTRF45/75/300	300			
MPSTRF45/100/100	100	100	2438 3000	
MPSTRF45/100/150	150			
MPSTRF45/100/200	200			
MPSTRF45/100/300	300			

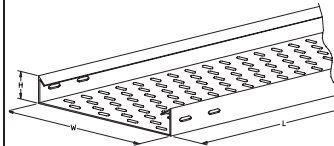

**45° FLANGE RETURN
(HEAVY DUTY)**

NOTE : Other sizes are available upon request

PART NO	W(mm)	H(mm)	L (mm)	MATERIAL & FINISHING
MPSTFR/50/75	75	50	2438 3000	Mild Steel / SS 304 / SS316 Thickness 1.5 to 2.0 mm
MPSTFR/50/100	100			
MPSTFR/50/150	150			
MPSTFR/50/300	300			
MPSTFR/75/100	100	75	2438 3000	HDG Accordance to ISO 1461 / BS 729 / ASTM A386
MPSTFR/75/150	150			
MPSTFR/75/200	200			
MPSTFR/75/300	300			
MPSTFR/100/100	100	100	2438 3000	
MPSTFR/100/150	150			
MPSTFR/100/200	200			
MPSTFR/100/300	300			

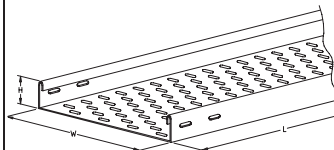

**FULL RETURN FLANGE
(HEAVY DUTY)**

NOTE : Other sizes are available upon request

REMARKS:

MP : METAL PERFORATORS
ST : STRAIGHT TRAY
UT : U TYPE
TH : TROUGH TYPE
RF45 : RETURN FLANGE 45°
FR : FULL RETURN FLANGE

EXAMPLE 1 :
MPSTUT/20/100
METAL PERFORATORS
STRAIGHT TRAY - U TYPE
20H X 100W

EXAMPLE 2 :
MPSTTH/50/150
METAL PERFORATORS
STRAIGHT TRAY - TROUGH TYPE
50H X 150W

WIRE MESH TRAY - HORIZONTAL ELBOW 90°

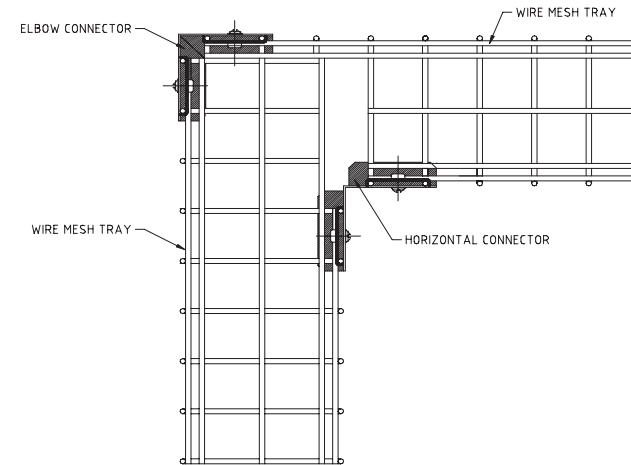

PLAN VIEW

SIDE VIEW

WIRE MESH TRAY - HORIZONTAL TEE

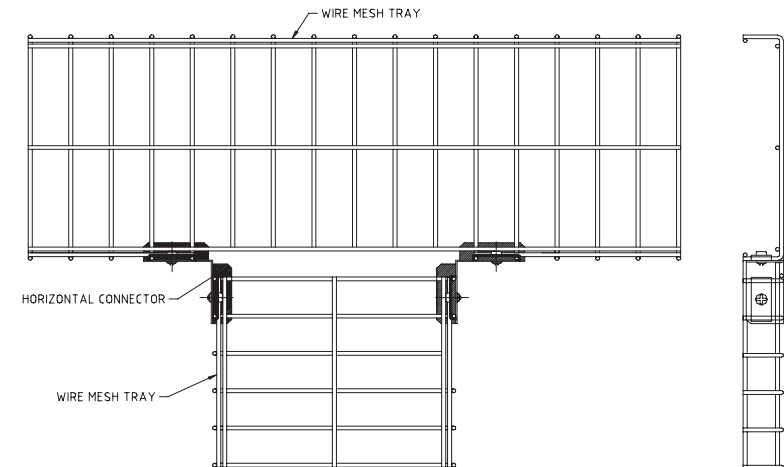

PLAN VIEW

SIDE VIEW

WIRE MESH TRAY - OUTSIDE RISER 90°

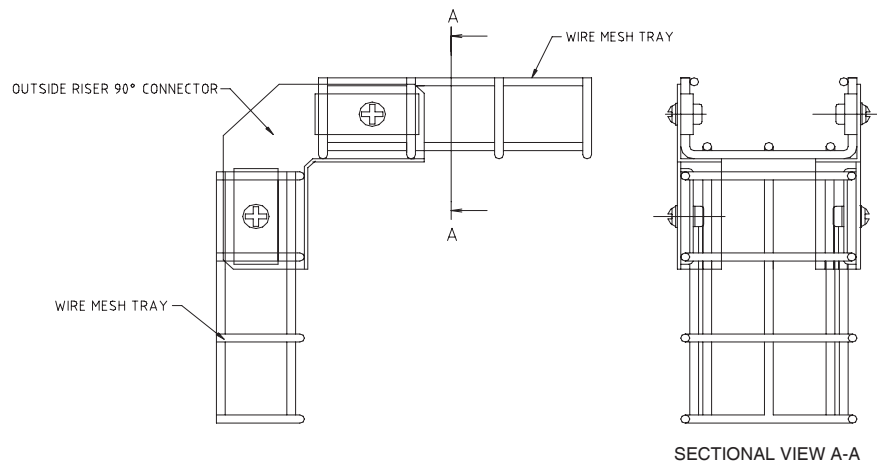

WIRE MESH TRAY - INSIDE RISER 90°

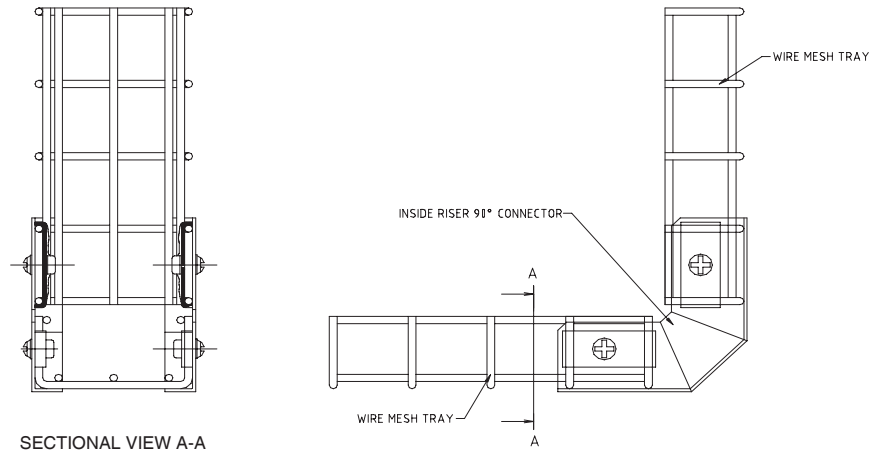

TRAY - HORIZONTAL ELBOW 90°

PART NO	W(mm)	H(mm)	R (mm)	MATERIAL & FINISHING
MPTUTEL90/15/50	50	13 15 20 50	R200	Mild Steel, SS 304, SS 316 Thickness 1.5 mm HDG Accordance to ISO 1461 / BS 729 / ASTM A386
MPTUTEL90/15/75	75			
MPTUTEL90/15/100	100			
MPTUTEL90/15/150	150			
MPTUTEL90/15/200	200			

NOTE : Other sizes are available upon request

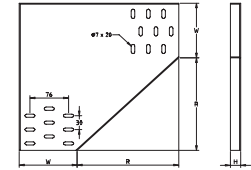

PART NO	W(mm)	H(mm)	R (mm)	MATERIAL & FINISHING						
MPTHEL90/50/75	75	50	R200 - R300	Mild Steel, SS 304, SS 316 Thickness 1.5 to 2.0 mm HDG Accordance to ISO 1461 / BS 729 / ASTM A386						
MPTHEL90/50/100	100									
MPTHEL90/50/150	150									
MPTHEL90/50/200	200									
MPTHEL90/75/100	100	75			R200 - R300	Mild Steel, SS 304, SS 316 Thickness 1.5 to 2.0 mm HDG Accordance to ISO 1461 / BS 729 / ASTM A386				
MPTHEL90/75/150	150									
MPTHEL90/75/200	200									
MPTHEL90/75/300	300	100					R200 - R300	Mild Steel, SS 304, SS 316 Thickness 1.5 to 2.0 mm HDG Accordance to ISO 1461 / BS 729 / ASTM A386		
MPTHEL90/100/100	100									
MPTHEL90/100/150	150									
MPTHEL90/100/200	200	300							R200 - R300	Mild Steel, SS 304, SS 316 Thickness 1.5 to 2.0 mm HDG Accordance to ISO 1461 / BS 729 / ASTM A386
MPTHEL90/100/300	300									

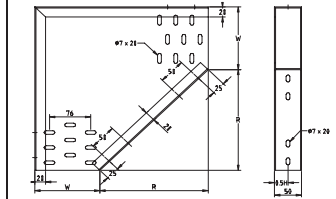

NOTE : Other sizes are available upon request

PART NO	W(mm)	H(mm)	R (mm)	MATERIAL & FINISHING						
MPCTR45H90/50/100	100	50	R200 - R300	Mild Steel, SS 304, SS 316 Thickness 1.5 to 2.0 mm HDG Accordance to ISO 1461 / BS 729 / ASTM A386						
MPCTR45H90/50/150	150									
MPCTR45H90/50/200	200									
MPCTR45H90/50/300	300									
MPCTR45H90/75/100	100	75			R200 - R300	Mild Steel, SS 304, SS 316 Thickness 1.5 to 2.0 mm HDG Accordance to ISO 1461 / BS 729 / ASTM A386				
MPCTR45H90/75/150	150									
MPCTR45H90/75/200	200									
MPCTR45H90/75/300	300	100					R200 - R300	Mild Steel, SS 304, SS 316 Thickness 1.5 to 2.0 mm HDG Accordance to ISO 1461 / BS 729 / ASTM A386		
MPCTR45H90/100/100	100									
MPCTR45H90/100/150	150									
MPCTR45H90/100/200	200	300							R200 - R300	Mild Steel, SS 304, SS 316 Thickness 1.5 to 2.0 mm HDG Accordance to ISO 1461 / BS 729 / ASTM A386
MPCTR45H90/100/300	300									

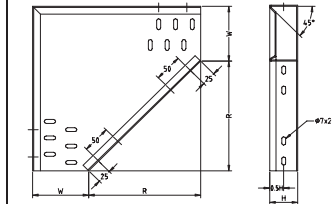

NOTE : Other sizes are available upon request

PART NO	W(mm)	H(mm)	R (mm)	MATERIAL & FINISHING						
MPCTFH90/50/100	100	50	R200 - R300	Mild Steel, SS 304, SS 316 Thickness 1.5 to 2.0 mm HDG Accordance to ISO 1461 / BS 729 / ASTM A386						
MPCTFH90/50/150	150									
MPCTFH90/50/200	200									
MPCTFH90/50/300	300									
MPCTFH90/75/100	100	75			R200 - R300	Mild Steel, SS 304, SS 316 Thickness 1.5 to 2.0 mm HDG Accordance to ISO 1461 / BS 729 / ASTM A386				
MPCTFH90/75/150	150									
MPCTFH90/75/200	200									
MPCTFH90/75/300	300	100					R200 - R300	Mild Steel, SS 304, SS 316 Thickness 1.5 to 2.0 mm HDG Accordance to ISO 1461 / BS 729 / ASTM A386		
MPCTFH90/100/100	100									
MPCTFH90/100/150	150									
MPCTFH90/100/200	200	300							R200 - R300	Mild Steel, SS 304, SS 316 Thickness 1.5 to 2.0 mm HDG Accordance to ISO 1461 / BS 729 / ASTM A386
MPCTFH90/100/300	300									

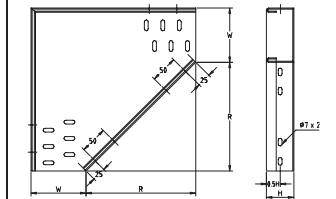

NOTE : Other sizes are available upon request

REMARKS:

MP : METAL PERFORATORS
T : TRAY
EL90 : ELBOW 90°
UT : U TYPE
TH : TROUGH TYPE
RF45 : RTN FLG 45°
FR : FULL RTN FLG

EXAMPLE 1 :

MPTUT90/15/100
METAL PERFORATORS
TRAY TROUGH TYPE ELBOW 90°
15H X 100W

EXAMPLE 2 :

MPTHEL90/50/150
METAL PERFORATORS
TRAY TROUGH TYPE ELBOW 90°
50H X 150W

TRAY - HORIZONTAL TEE

PART NO	W(mm)	H(mm)	R (mm)	MATERIAL & FINISHING
MPTTHT/15/50	50	13 15 20 50	R200	Mild Steel, SS 304, SS 316
MPTTHT/15/75	75			Thickness 1.5 mm
MPTTHT/15/100	100			
MPTTHT/15/150	150			
MPTTHT/15/200	200			HDG Accordance to ISO 1461 / BS 729 / ASTM A386

NOTE : Other sizes are available upon request

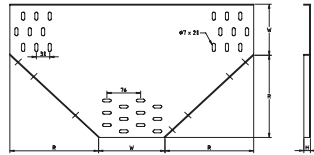

PART NO	W(mm)	H(mm)	R (mm)	MATERIAL & FINISHING
MPTTHT/50/75	75	50	R200 - R300	Mild Steel, SS 304, SS 316
MPTTHT/50/100	100			Thickness 1.5 to 2.0 mm
MPTTHT/50/200	150			
MPTTHT/50/300	200			
MPCTHT/75/100	100	75	R200 - R300	HDG Accordance to ISO 1461 / BS 729 / ASTM A386
MPTTHT/75/150	150			
MPTTHT/75/200	200			
MPTTHT/75/300	300			
MPTTHT/100/100	100	100	R200 - R300	
MPTTHT/100/150	150			
MPTTHT/100/200	200			
MPTTHT/100/300	300			

NOTE : Other sizes are available upon request

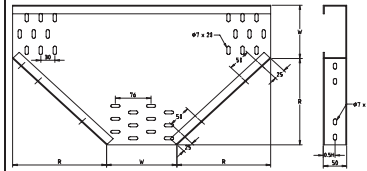

PART NO	W(mm)	H(mm)	R (mm)	MATERIAL & FINISHING
MPTRF45HT/50/75	75	50	R200 - R300	Mild Steel, SS 304, SS 316
MPTRF45HT/50/100	100			Thickness 1.5 to 2.0 mm
MPTRF45HT/50/150	150			
MPTRF45HT/50/200	200			
MPTRF45HT/75/100	100	75	R200 - R300	HDG Accordance to ISO 1461 / BS 729 / ASTM A386
MPTRF45HT/75/150	150			
MPTRF45HT/75/200	200			
MPTRF45HT/75/300	300			
MPTRF45HT/100/100	100	100	R200 - R300	
MPTRF45HT/100/150	150			
MPTRF45HT/100/200	200			
MPTRF45HT/100/300	300			

NOTE : Other sizes are available upon request

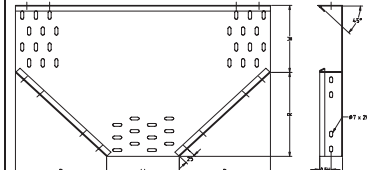

PART NO	W(mm)	H(mm)	R (mm)	MATERIAL & FINISHING
MPTFRHT/50/75	75	50	R200 - R300	Mild Steel, SS 304, SS 316
MPTFRHT/50/100	100			Thickness 1.5 to 2.0 mm
MPTFRHT/50/150	150			
MPTFRHT/50/200	200			
MPTFRHT/75/100	100	75	R200 - R300	HDG Accordance to ISO 1461 / BS 729 / ASTM A386
MPTFRHT/75/150	150			
MPTFRHT/75/200	200			
MPTFRHT/75/300	300			
MPTFRHT/100/100	100	100	R200 - R300	
MPTFRHT/100/150	150			
MPTFRHT/100/200	200			
MPTFRHT/100/300	300			

NOTE : Other sizes are available upon request

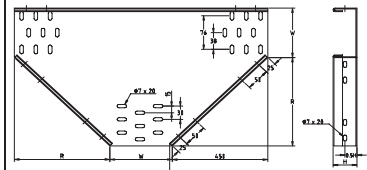

REMARKS:

MP : METAL PERFORATORS
T : TRAY
HT : HORIZONTAL TEE
UT : U TYPE
TH : TROUGH TYPE
RF45 : RETURN FLANGE 45°
FR : FULL RTN FLG

EXAMPLE 1: MPTTHT/15/100
METAL PERFORATORS
TRAY U TYPE HORIZONTAL TEE
15H X 100W

EXAMPLE 1: MPTTHT/50/200
METAL PERFORATOR
TRAY TROUGH TYPE HORIZONTAL TEE
50H X 200W

WIRE MESH TRAY PROFILE

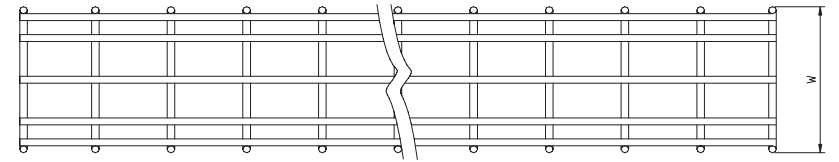

PLAN VIEW

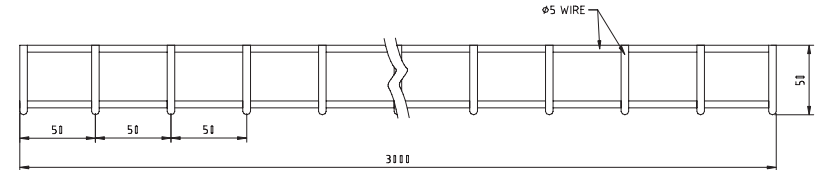

FRONT ELEV. VIEW

STANDARD SPECIFICATION

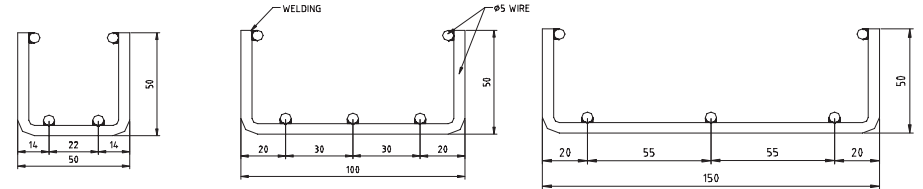

PART NO:
MPWM/50/50

PART NO: MPWM/50/100

PART NO: MPWM/50/150

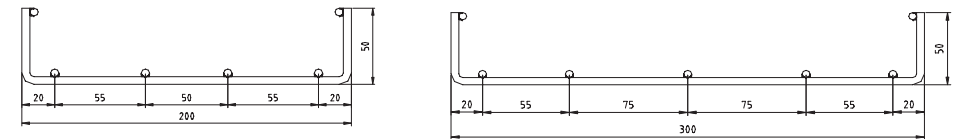

PART NO: MPWM/50/200

PART NO: MPWM/50/300

REMARKS

MP : METAL PERFORATORS
WM : WIRE MESH TRAY

EXAMPLE: MPWM/50/100

METAL PERFORATOR
WIRE MESH TRAY
50H x 100W

TRAY - INSIDE RISER 90°

PART NO	W(mm)	H(mm)	R (mm)	MATERIAL & FINISHING
MPTTUIR90/15/50	50	13 15 20 50	R200	Mild Steel, SS 304, SS 316 Thickness 1.5 mm HDG Accordance to ISO 1461 / BS 729 / ASTM A386
MPTTUIR90/15/100	75			
MPTTUIR90/15/100	100			
MPTTUIR90/15/150	150			
MPTTUIR90/15/200	200			

NOTE : Other sizes are available upon request

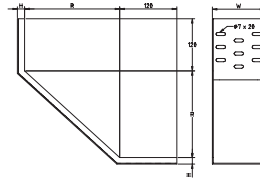

PART NO	W(mm)	H(mm)	R (mm)	MATERIAL & FINISHING
MPTTHIR90/50/75	75	50	R200 - R300	Mild Steel, SS 304, SS 316 Thickness 1.5 to 2.0 mm
MPTTHIR90/50/100	100			
MPTTHIR90/50/150	150			
MPTTHIR90/50/200	200			
MPTTHIR90/75/100	100	75		HDG Accordance to ISO 1461 / BS 729 / ASTM A386
MPTTHIR90/75/150	150			
MPTTHIR90/75/200	200			
MPTTHIR90/75/300	300			
MPTTHIR90/100/100	100	100		
MPTTHIR90/100/150	150			
MPTTHIR90/100/200	200			
MPTTHIR90/100/300	300			

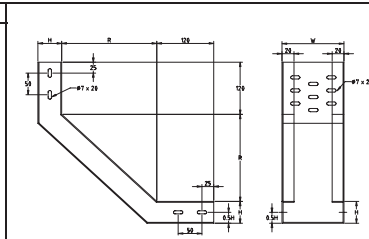

NOTE : Other sizes are available upon request

PART NO	W(mm)	H(mm)	R (mm)	MATERIAL & FINISHING
MPTRF45IR90/50/75	75	50	R200 - R300	Mild Steel, SS 304, SS 316 Thickness 1.5 to 2.0 mm
MPTRF45IR90/50/100	100			
MPTRF45IR90/50/150	150			
MPTRF45IR90/50/200	200			
MPTRF45IR90/75/100	100	75		HDG Accordance to ISO 1461 / BS 729 / ASTM A386
MPTRF45IR90/75/150	150			
MPTRF45IR90/75/200	200			
MPTRF45IR90/75/300	300			
MPTRF45IR90/100/100	100	100		
MPTRF45IR90/100/150	150			
MPTRF45IR90/100/200	200			
MPTRF45IR90/100/300	300			

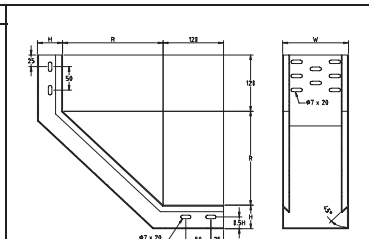

NOTE : Other sizes are available upon request

PART NO	W(mm)	H(mm)	R (mm)	MATERIAL & FINISHING
MPTFRIR90/50/75	75	50	R200 - R300	Mild Steel, SS 304, SS 316 Thickness 1.5 to 2.0 mm
MPTFRIR90/50/100	100			
MPTFRIR90/50/150	150			
MPTFRIR90/50/200	200			
MPTFRIR90/75/100	100	75		HDG Accordance to ISO 1461 / BS 729 / ASTM A386
MPTFRIR90/75/150	150			
MPTFRIR90/75/200	200			
MPTFRIR90/75/300	300			
MPTFRIR90/100/100	100	100		
MPTFRIR90/100/150	150			
MPTFRIR90/100/200	200			
MPTFRIR90/100/300	300			

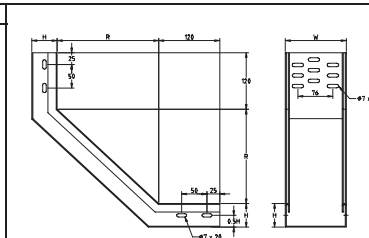

NOTE : Other sizes are available upon request

REMARKS:

MP : METAL PERFORATORS
T : TRAY
IR90 : INSIDE RISER 90°
UT : U TYPE
TH : TROUGH TYPE
RF45 : RETURN FLANGE 45°
FR : FULL RTN FLG

EXAMPLE 1: MPTUIR90/15/100
METAL PERFORATORS
TRAY U TYPE INSIDE RISER 90°
15H X 100W

EXAMPLE 1: MPTTHIR90/50/200
METAL PERFORATOR
TRAY TROUGH TYPE INSIDE RISER 90°
50H X 200W



WIRE MESH CABLE TRAY

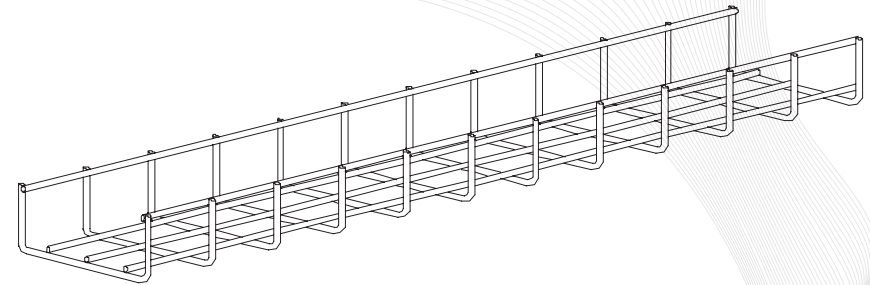

LOADING DATA FOR CABLE TRAY

PERFORATED CABLE TRAY - TROUGH TYPE

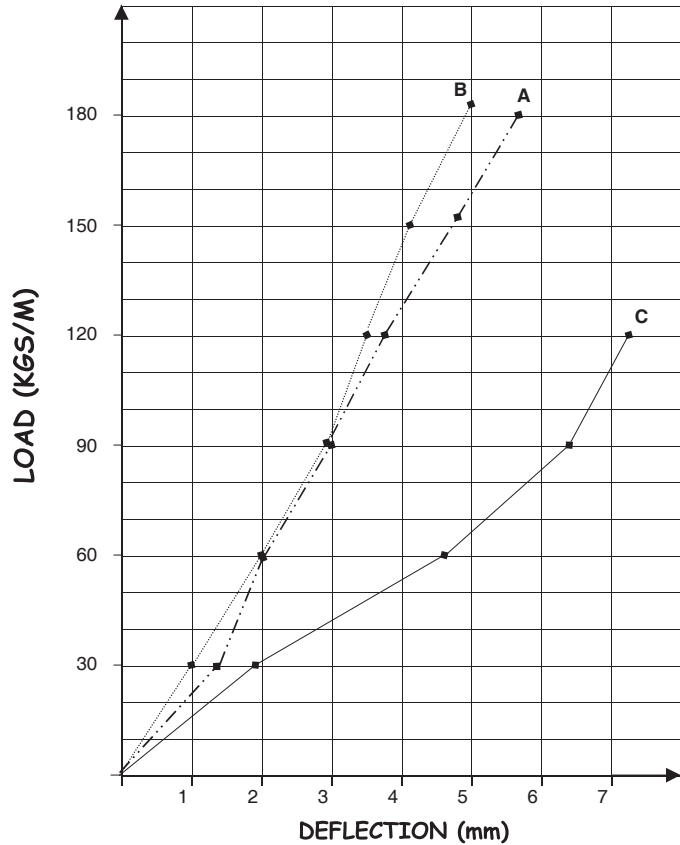

- A** - - - - - 2 M SPAN (300w x 50H x 2438L x 2T)
- B** 2 M SPAN (150w x 50H x 2438L x 2T)
- C** ——— 2 M SPAN (100w x 50H x 2438L x 2T)

TRAY - OUTSIDE RISER 90°

PART NO	W(mm)	H(mm)	R (mm)	MATERIAL & FINISHING
MPTUTOR90/15/50	50	13	R200	Mild Steel, SS 304, SS 316 Thickness 1.5 mm HDG Accordance to ISO 1461 / BS 729 / ASTM A386
MPTUTOR90/15/100	75			
MPTUTOR90/15/100	100			
MPTUTOR90/15/150	150			
MPTUTOR90/15/200	200			

NOTE : Other sizes are available upon request

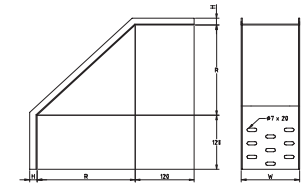

PART NO	W(mm)	H(mm)	R (mm)	MATERIAL & FINISHING
MPTTHOR90/50/75	75	50	R200 - R300	Mild Steel, SS 304, SS 316 Thickness 1.5 to 2.0 mm HDG Accordance to ISO 1461 / BS 729 / ASTM A386
MPTTHOR90/50/100	100			
MPTTHOR90/50/150	150			
MPTTHOR90/50/200	200			
MPTTHOR90/75/100	100	75		
MPTTHOR90/75/150	150			
MPTTHOR90/75/200	200			
MPTTHOR90/75/300	300	100		
MPTTHOR90/100/100	100			
MPTTHOR90/100/150	150			
MPTTHOR90/100/200	200			
MPTTHOR90/100/300	300			

NOTE : Other sizes are available upon request

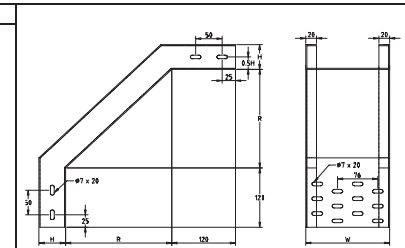

PART NO	W(mm)	H(mm)	R (mm)	MATERIAL & FINISHING
MPTRF45OR90/50/75	75	50	R200 - R300	Mild Steel, SS 304, SS 316 Thickness 1.5 to 2.0 mm HDG Accordance to ISO 1461 / BS 729 / ASTM A386
MPTRF45OR90/50/100	100			
MPTRF45OR90/50/150	150			
MPTRF45OR90/50/200	200			
MPTRF45OR90/75/100	100	75		
MPTRF45OR90/75/150	150			
MPTRF45OR90/75/200	200			
MPTRF45OR90/75/300	300	100		
MPTRF45OR90/100/100	100			
MPTRF45OR90/100/150	150			
MPTRF45OR90/100/200	200			
MPTRF45OR90/100/300	300			

NOTE : Other sizes are available upon request

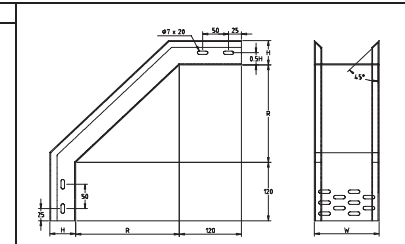

PART NO	W(mm)	H(mm)	R (mm)	MATERIAL & FINISHING
MPTFROR90/50/75	75	50	R200 - R300	Mild Steel, SS 304, SS 316 Thickness 1.5 to 2.0 mm HDG Accordance to ISO 1461 / BS 729 / ASTM A386
MPTFROR90/50/100	100			
MPTFROR90/50/150	150			
MPTFROR90/50/200	200			
MPTFROR90/75/100	100	75		
MPTFROR90/75/150	150			
MPTFROR90/75/200	200			
MPTFROR90/75/300	300	100		
MPTFROR90/100/100	100			
MPTFROR90/100/150	150			
MPTFROR90/100/200	200			
MPTFROR90/100/300	300			

NOTE : Other sizes are available upon request

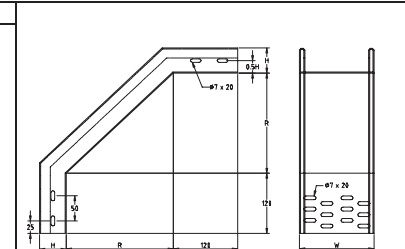

REMARKS:

MP : METAL PERFORATORS
T : TRAY
OR90 : OUTSIDE RISER 90°
UT : U TYPE
TH : TROUGH TYPE
RF45 : RETURN FLG 45°
FR : FULL RTN FLG

EXAMPLE 1: MPTUTOR90/15/100

METAL PERFORATORS
TRAY U TYPE OUTSIDE RISER 90°
15H X 100W

EXAMPLE 1: MPTTHOR90/50/200

METAL PERFORATOR
TRAY TROUGH TYPE OUTSIDE RISER 90°
50H X 200W

TRAY - STRAIGHT REDUCER

PART NO	W(mm)	W1(mm)	H(mm)	MATERIAL & FINISHING
MPTUTSR/15/75-50	75	50	13	Mild Steel, SS 304, SS 316
MPTUTSR/15/100-75	100	75		
MPTUTSR/15/150-100	150	100	15	Thickness 1.5 mm
MPTUTSR/15/200-150	200	150	20	HDG Accordance to
MPTUTSR/15/300-200	300	200	50	ISO 1461 / BS 729 / ASTM A386

NOTE : Other sizes are available upon request

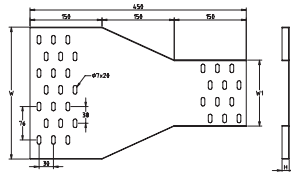

PART NO	W(mm)	W1(mm)	H(mm)	MATERIAL & FINISHING
MPTTHSR/50/100-75	100	75	50	Mild Steel, SS 304, SS 316
MPTTHSR/50/150-100	150	100		
MPTTHSR/50/200-150	200	150	75	Thickness 1.5 to 2.0 mm
MPTTHSR/50/300-200	300	200		
MPTTHSR/75/100-75	100	75	100	HDG Accordance to ISO 1461 / BS 729 / ASTM A386
MPTTHSR/75/150-100	150	100		
MPTTHSR/75/200-150	200	150	100	HDG Accordance to ISO 1461 / BS 729 / ASTM A386
MPTTHSR/75/300-200	300	200		
MPTTHSR/100/100-75	100	75	100	HDG Accordance to ISO 1461 / BS 729 / ASTM A386
MPTTHSR/100/150-100	150	100		
MPTTHSR/100/200-150	200	150	100	HDG Accordance to ISO 1461 / BS 729 / ASTM A386
MPTTHSR/100/300-200	300	200		

NOTE : Other sizes are available upon request

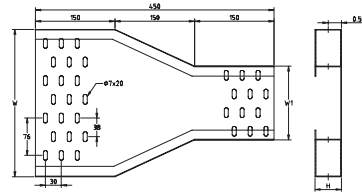

PART NO	W(mm)	W1(mm)	H(mm)	MATERIAL & FINISHING
MPTRF45SR/50/100-75	100	75	50	Mild Steel, SS 304, SS 316
MPTRF45SR/50/150-100	150	100		
MPTRF45SR/50/200-150	200	150	75	Thickness 1.5 to 2.0 mm
MPTRF45SR/50/300-200	300	200		
MPTRF45SR/75/100-75	100	75	100	HDG Accordance to ISO 1461 / BS 729 / ASTM A386
MPTRF45SR/75/150-100	150	100		
MPTRF45SR/75/200-150	200	150	100	HDG Accordance to ISO 1461 / BS 729 / ASTM A386
MPTRF45SR/75/300-200	300	200		
MPTRF45SR/100/100-75	100	75	100	HDG Accordance to ISO 1461 / BS 729 / ASTM A386
MPTRF45SR/100/150-100	150	100		
MPTRF45SR/100/200-150	200	150	100	HDG Accordance to ISO 1461 / BS 729 / ASTM A386
MPTRF45SR/100/300-200	300	200		

NOTE : Other sizes are available upon request

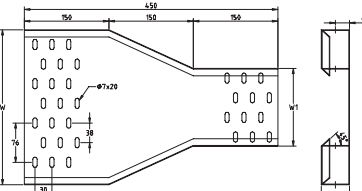

PART NO	W(mm)	W1(mm)	H(mm)	MATERIAL & FINISHING
MPTFRSR/50/100-75	100	75	50	Mild Steel, SS 304, SS 316
MPTFRSR/50/150-100	150	100		
MPTFRSR/50/200-150	200	150	75	Thickness 1.5 to 2.0 mm
MPTFRSR/50/300-200	300	200		
MPTFRSR/75/100-75	100	75	100	HDG Accordance to ISO 1461 / BS 729 / ASTM A386
MPTFRSR/75/150-100	150	100		
MPTFRSR/75/200-150	200	150	100	HDG Accordance to ISO 1461 / BS 729 / ASTM A386
MPTFRSR/75/300-200	300	200		
MPTFRSR/100/100-75	100	50	100	HDG Accordance to ISO 1461 / BS 729 / ASTM A386
MPTFRSR/100/150-100	150	100		
MPTFRSR/100/200-150	200	150	100	HDG Accordance to ISO 1461 / BS 729 / ASTM A386
MPTFRSR/100/300-200	300	200		

NOTE : Other sizes are available upon request

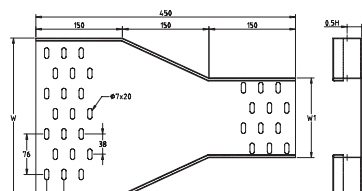

REMARKS:

MP : METAL PERFORATORS
T : TRAY
SR : STRAIGHT REDUCER
UT : U TYPE
TH : TROUGH TYPE
RF45 : RETURN FLANGE 45°
FR : FULL RTN FLG

EXAMPLE 1: MPTUTSR/15/100

METAL PERFORATORS
TRAY U TYPE STRAIGHT REDUCER
15H X 100W

EXAMPLE 1: MPTTHSR/50/200

METAL PERFORATOR
TRAY TROUGH TYPE STRAIGHT REDUCER
50H X 200W

TRAY - OFFSET REDUCER (LEFT/RIGHT)

PART NO	W(mm)	W1(mm)	H(mm)	MATERIAL & FINISHING
MPTUTRL/15/75-50	75	50	13	Mild Steel, SS 304, SS 316
MPTUTRL/15/100-75	100	75		
MPTUTRL/15/150-100	150	100	15	Thickness 1.5 mm
MPTUTRL/15/200-150	200	150	20	HDG Accordance to
MPTUTRL/15/300-200	300	200	50	ISO 1461 / BS 729 / ASTM A386

NOTE : Other sizes are available upon request

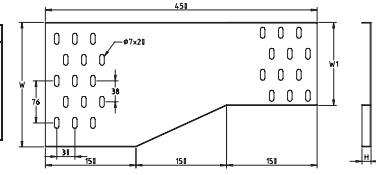

PART NO	W(mm)	W1(mm)	H(mm)	MATERIAL & FINISHING
MPTHRL/50/75-50	75	50	50	Mild Steel, SS 304, SS 316
MPTHRL/50/100-75	100	75		
MPTHRL/50/150-100	150	100	75	Thickness 1.5 to 2.0 mm
MPTHRL/50/200-150	200	150		
MPTHRL/75/100-75	100	75	100	HDG Accordance to ISO 1461 / BS 729 / ASTM A386
MPTHRL/75/150-100	150	100		
MPTHRL/75/200-150	200	150	100	HDG Accordance to ISO 1461 / BS 729 / ASTM A386
MPTHRL/75/300-200	300	200		
MPTHRL/100/100-75	100	75	100	HDG Accordance to ISO 1461 / BS 729 / ASTM A386
MPTHRL/100/150-100	150	100		
MPTHRL/100/200-150	200	150	100	HDG Accordance to ISO 1461 / BS 729 / ASTM A386
MPTHRL/100/300-200	300	200		

NOTE : Other sizes are available upon request

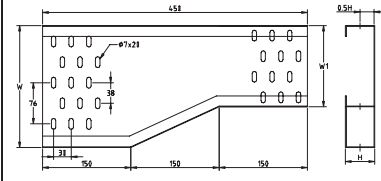

PART NO	W(mm)	W1(mm)	H(mm)	MATERIAL & FINISHING
MPTRF45RL/50/100-75	100	75	50	Mild Steel, SS 304, SS 316
MPTRF45RL/50/150-100	150	100		
MPTRF45RL/50/200-150	200	150	75	Thickness 1.5 to 2.0 mm
MPTRF45RL/50/300-200	300	200		
MPTRF45RL/75/100-75	100	75	100	HDG Accordance to ISO 1461 / BS 729 / ASTM A386
MPTRF45RL/75/150-100	150	100		
MPTRF45RL/75/200-150	200	150	100	HDG Accordance to ISO 1461 / BS 729 / ASTM A386
MPTRF45RL/75/300-200	300	200		
MPTRF45RL/100/100-75	100	75	100	HDG Accordance to ISO 1461 / BS 729 / ASTM A386
MPTRF45RL/100/150-100	150	100		
MPTRF45RL/100/200-150	200	150	100	HDG Accordance to ISO 1461 / BS 729 / ASTM A386
MPTRF45RL/100/300-200	300	200		

NOTE : Other sizes are available upon request

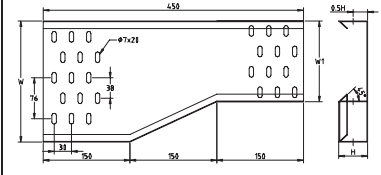

PART NO	W(mm)	W1(mm)	H(mm)	MATERIAL & FINISHING
MPTFRRL/50/100-75	100	75	50	Mild Steel, SS 304, SS 316
MPTFRRL/50/150-100	150	100		
MPTFRRL/50/200-150	200	150	75	Thickness 1.5 to 2.0 mm
MPTFRRL/50/300-200	300	200		
MPTFRRL/75/100-75	100	75	100	HDG Accordance to ISO 1461 / BS 729 / ASTM A386
MPTFRRL/75/150-100	150	100		
MPTFRRL/75/200-150	200	150	100	HDG Accordance to ISO 1461 / BS 729 / ASTM A386
MPTFRRL/75/300-200	300	200		
MPTFRRL/100/100-75	100	75	100	HDG Accordance to ISO 1461 / BS 729 / ASTM A386
MPTFRRL/100/150-100	150	100		
MPTFRRL/100/200-150	200	150	100	HDG Accordance to ISO 1461 / BS 729 / ASTM A386
MPTFRRL/100/300-200	300	200		

NOTE : Other sizes are available upon request

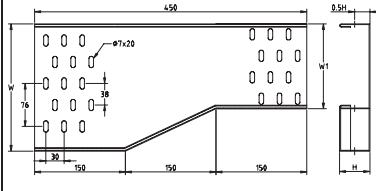

REMARKS:

MP : METAL PERFORATORS
T : TRAY
RL : REDUCER LEFT
RR : REDUCER RIGHT
UT : U TYPE
TH : TROUGH TYPE
RF45 : RETURN FLANGE 45°

EXAMPLE 1: MPTUTRL/15/75-50
METAL PERFORATORS
TRAY U TYPE REDUCER LEFT
15H X 75W-50W

EXAMPLE 1: MPTUTRR/15/75-50
METAL PERFORATOR
TRAY U TYPE REDUCER RIGHT
15H X 75W-50W